

1 2 3 4 5 6 7 8

REV	LOCATIONS	DESCRIPTION	DATE	REVISER	APPD

SPECIFICATIONS

Electrical  
 Current Rating: 1.5A AC/DC(28 AWG)  
 Voltage Rating: 50V AC/DC(rms)  
 Contact Resistance: 20mΩ MAX  
 Insulation Resistance: 100 MΩ MIN  
 Withstanding Voltage: 500V AC/minute  
 Temperature Range—Operating: -40°C~+105°C  
 Apply to gauge: 28AWG~30AWG(O.D 0.5mm~0.7mm)  
 Material: Phosphor bronze,Gold flash  
 Mates With Housing: FHG12003 Series

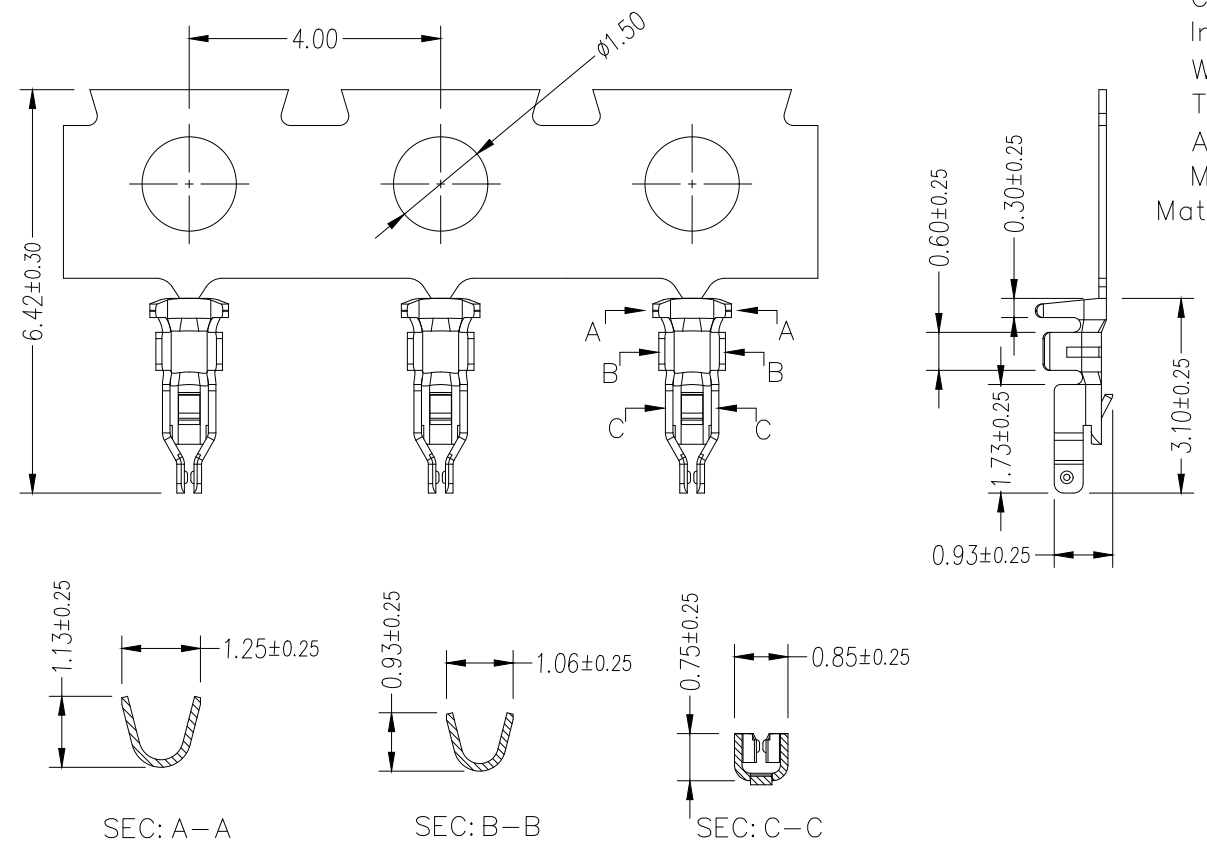

A  
B  
C  
D  
E  
F

A  
B  
C  
D  
E  
F

1 2 3 4 5 6 7 8

<p>THIRD ANGLE PROJECTION</p>	GENERAL TOLERANCES (UNLESS SPECIFIED)		APPROVE BY	DATE	PART NO.	ITEM NO.	<p>Building Technology Cornerstone</p>	
	X. ±0.30	X.* ±5'	LEO	21/Oct/21	FT12003-F1H	FT12003		
	DESIGN UNITS mm		CHECKED BY	DATE	TITLE		REV 0	SHEET NO. 1/2
	SCALE 5:1	SIZE A4	GISELLE	21/Oct/21	Wire to Board Pitch 1.20mm (Terminal)		THIS DRAWING CONTAINS INFORMATION THAT IS PROPRIETARY TO TXGA INDUSTRIAL ELECTRONICS(S.Z)CO.,LTD AND SHOULD NOT BE USED WITHOUT WRITTEN PERMISSION	
		X.XX ±0.15	X.XX' ±1'	DRAWN BY	DATE			
		X.XXX ±0.10	X.XXX' ±0.5'	PYD	21/Oct/21			

1 2 3 4 5 6 7 8

REV	LOCATIONS	DESCRIPTION	DATE	REVISER	APPD

A  
B  
C  
D  
E  
F

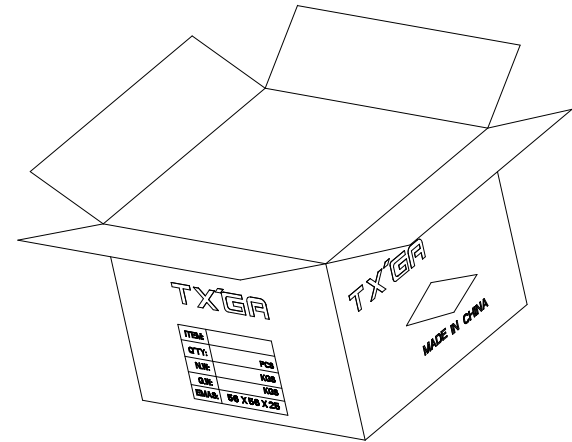
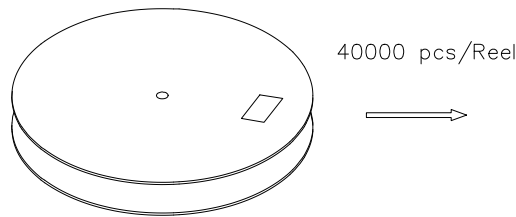
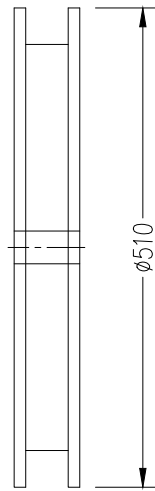
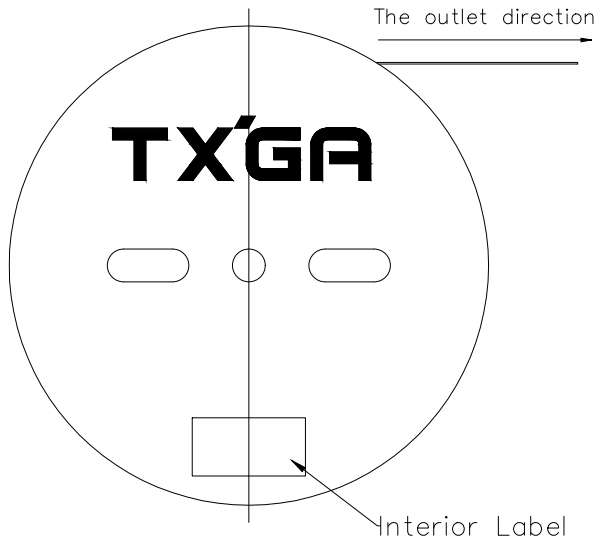

A  
B  
C  
D  
E  
F

1 2 3 4 5 6 7 8

<p>THIRD ANGLE PROJECTION</p>	GENERAL TOLERANCES (UNLESS SPECIFIED)		APPROVE BY	DATE	PART NO.	ITEM NO.	<p>Building Technology Cornerstone</p>
	X. ±0.30	X.* ±5'	LEO	21/Oct/21	FT12003-F1H	FT12003	
	DESIGN UNITS mm		CHECKED BY	DATE	TITLE		REV 0    SHEET NO. 2/2
	X.X ±0.20	X.X' ±2'	GISELLE	21/Oct/21	Wire to Board Pitch 1.20mm (Terminal)		
SCALE 5:1	SIZE A4	X.XX ±0.15	X.XX' ±1'	DRAWN BY	DATE	THIS DRAWING CONTAINS INFORMATION THAT IS PROPRIETARY TO TXGA INDUSTRIAL ELECTRONICS(S.Z)CO.,LTD AND SHOULD NOT BE USED WITHOUT WRITTEN PERMISSION	
X.XXX ±0.10	X.XXX' ±0.5'	PYD	21/Oct/21				