

REV	LOCATIONS	DESCRIPTION	DATE	REVISER	APPD
1		Dimension: Change 10.60 into 10.7±0.2mm	31/JUL/17	KATE	FRANK
2		Add dimension, Corrected the Pin assignment	01/SEP/20	KATE	CHERRY

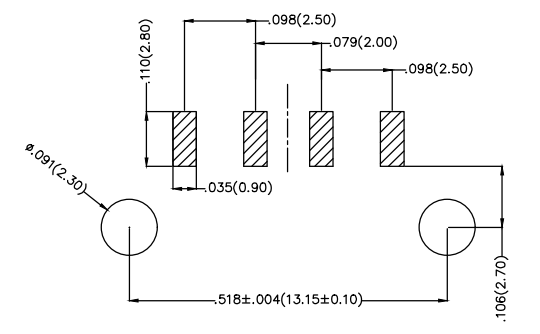
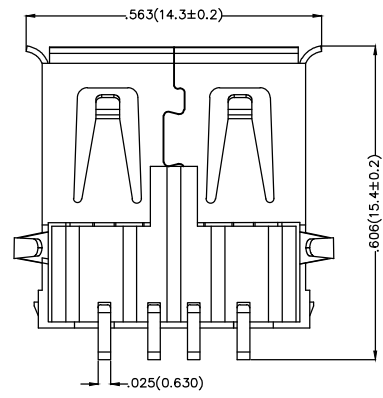
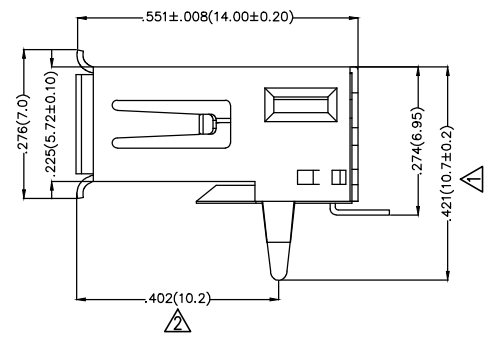
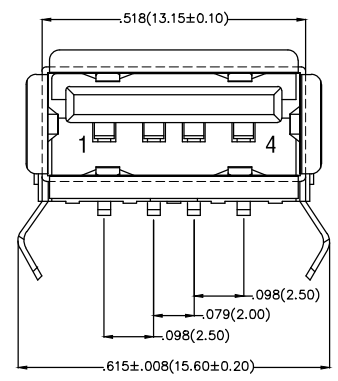

Recommended P.C.Board Layout

Electrical

Current Rating: 1A AC(rms)/DC
Voltage Rating: 30V AC(rms)/DC
Contact Resistance: 30 mΩ Max
Insulation Resistance: 1000 MΩ Min
Withstanding Voltage: 500V AC r.m.s
Temperature Range-Operating: -55°C~+105°C

Material and Plating

Housing: LCP (UL 94V-0)
Contact Pin: Phosphor Bronze
Plating: Gold in contact area, tin on tail.
Shell: Brass/ Nickel plated

Pin assignment

Circuits	Signal name
1	VBUS
2	D-
3	D+
4	GND

 THIRD ANGLE PROJECTION	GENERAL TOLERANCES (UNLESS SPECIFIED)		APPROVE BY	DATE	PART NO.	ITEM NO.	 Leader Of Industry	
	X.±.012(0.30)	X.'±5'	FRANK	25/JUN/13	FUS201-FSBK6K	FUS201		
	DESIGN UNITS Inch (metric)	X.X±.008(0.20)	.X'±2'	CHECKED BY	DATE	TITLE		REV 2 SHEET NO. 1/1
	SCALE	X.XX±.006(0.15)	.XX'±1'	JACOB	25/JUN/13	USB A-type 4Circuits 90°Angle Female(SMT)		
SIZE	X.XXX±.004(0.10)	.XXX'±0.5'	DRAWN BY	DATE	THIS DRAWING CONTAINS INFORMATION THAT IS PROPRIETARY TO TXGA INDUSTRIAL ELECTRONICS(S.Z)CO.,LTD AND SHOULD NOT BE USED WITHOUT WRITTEN PERMISSION			
5:1	A4		CHERRY	25/JUN/13				