

REV	LOCATIONS	DESCRIPTION	DATE	REVISER	APPD
1	△	Structure change	03/APR/20	KATE	CHERRY

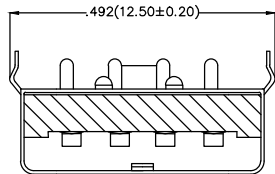
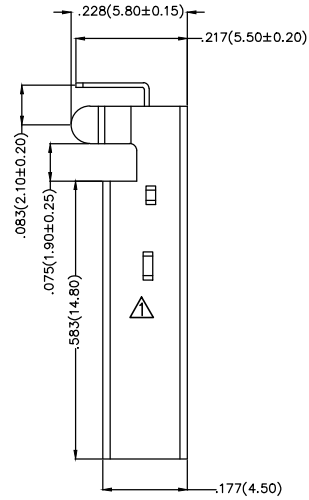
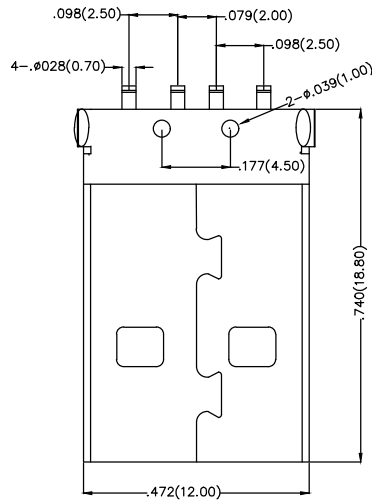

Electrical

Current Rating: 1A AC(rms)/DC

Voltage Rating: 30V AC(rms)/DC

Contact Resistance: 30 mΩ Max

Insulation Resistance: 500 MΩ MIN

Withstanding Voltage: 500V AC r.m.s

Temperature Range-Operating: -40°C~+85°C

Material and Plating

Housing: PA66(UL 94V-0)

Contact Pin: Phosphor Bronze

Plating: Selective gold in contact area, Tin on tail.

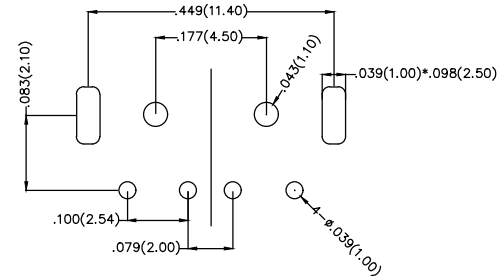

Recommended P.C.Board Layout

<p>THIRD ANGLE PROJECTION</p>	GENERAL TOLERANCES (UNLESS SPECIFIED)		APPROVE BY	DATE	PART NO.	ITEM NO.	<p>Leader Of Industry</p>	
	X.±.012(0.30)	X.'±5'	FRANK	17JUL/13	FUS215-MDBK6K	FUS215		
	DESIGN UNITS Inch (metric)	X.X±.008(0.20)	.X'±2'	CHECKED BY	DATE	TITLE		REV 1 SHEET NO. 1/1
	SCALE	X.XX±.006(0.15)	.XX'±1'	CHERRY	17/JUL/13	USB A-type 4Circuits 90°Angle Male(DIP)		
SIZE	X.XXX±.004(0.10)	.XXX'±0.5'	DRAWN BY	DATE	THIS DRAWING CONTAINS INFORMATION THAT IS PROPRIETARY TO TXGA INDUSTRIAL ELECTRONICS(S.Z)CO.,LTD AND SHOULD NOT BE USED WITHOUT WRITTEN PERMISSION			
5:1	A4		JACOB	17/JUL/13				