

REV	LOCATIONS	DESCRIPTION	DATE	REVISER	APPD

SPECIFICATIONS

Electrical
 Current Rating: 1.0A AC(rms)/DC
 Voltage Rating: 30V AC(rms)/DC
 Contact Resistance: 30 mΩ Max
 Withstanding Voltage: 500V AC r.m.s
 Insulation Resistance: 1000 MΩ Min
 Temperature Range-Operating: -25°C~+85°C

Mechanical
 Insertion Force: 3.5Kgf Max
 Withdrawal Force: 1.02Kgf Min

Material
 Housing: Thermoplastic (UL 94V-0) , Black
 Terminal: Copper alloy
 Shell: SPCC

Plating
 Terminal: Gold in contact area, tin on tail
 Shell: Nickel plated

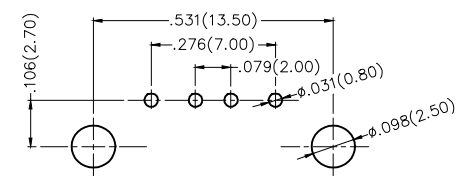
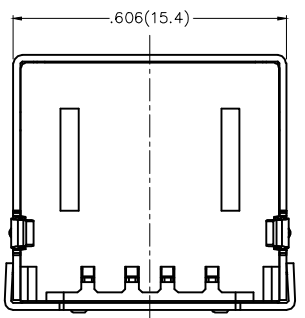
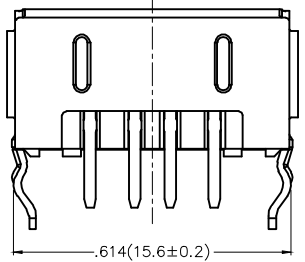
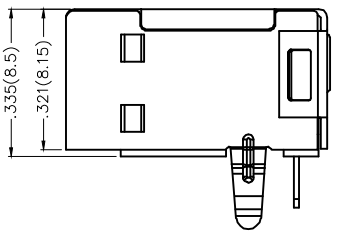
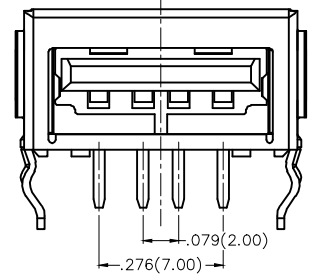
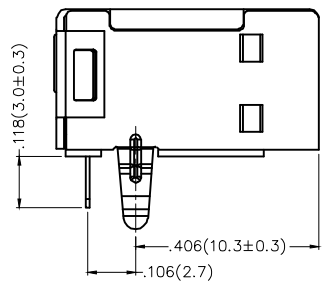
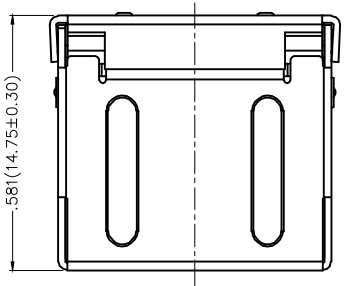

Recommended P.C.Board Layout

<p>THIRD ANGLE PROJECTION</p>	GENERAL TOLERANCES (UNLESS SPECIFIED)		APPROVE BY FRANK	DATE 08/SEP/18	PART NO. FUS280-FDBK6K	ITEM NO. FUS280	<p>Leader Of Industry</p>	
	X.±.012(0.30)	X'.±5'	CHECKED BY CHERRY	DATE 08/SEP/18	TITLE USB A-type 4Circuits 90°Angle Female(DIP)			REV 0
	DESIGN UNITS Inch (metric)	X.X±.008(0.20)	.X'±2'	DRAWN BY KATE	DATE 08/SEP/18	THIS DRAWING CONTAINS INFORMATION THAT IS PROPRIETARY TO TXGA INDUSTRIAL ELECTRONICS(S.Z)CO.,LTD AND SHOULD NOT BE USED WITHOUT WRITTEN PERMISSION		
	SCALE 5:1	SIZE A4	X.XX±.006(0.15)	.XX'±1'	X.XXX±.004(0.10)	.XXX±0.5'		