

1 2 3 4 5 6 7 8

REV	LOCATIONS	DESCRIPTION	DATE	REVISER	APPD

**SPECIFICATIONS**

**Electrical**  
 Current Rating: 1.5A AC(rms)/DC  
 Voltage Rating: 30V AC(rms)/DC  
 Contact Resistance: 30 mΩ Max  
 Withstanding Voltage: 500V AC r.m.s  
 Insulation Resistance: 1000 MΩ Min  
 Temperature Range—Operating: -25°C~+85°C

**Mechanical**  
 Insertion Force: 3.5Kgf Max  
 Withdrawal Force: 1.02Kgf Min  
 Terminal retention: 1.0kgf Min

**Material**  
 Housing: Thermoplastic (UL 94V-0) , White  
 Terminal: Copper alloy  
 Shell: Copper alloy

**Plating**  
 Terminal: Gold plated on contact area and bright tin plated on tails area  
 Shell: Nickel plated

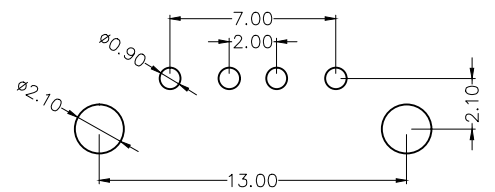
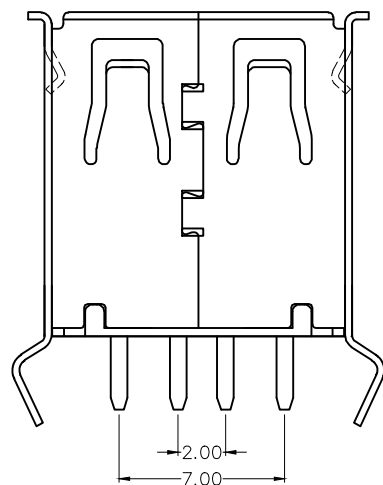
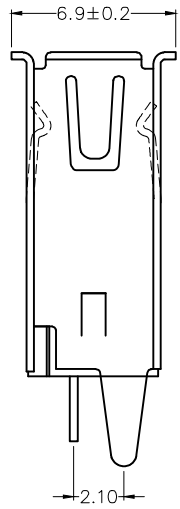
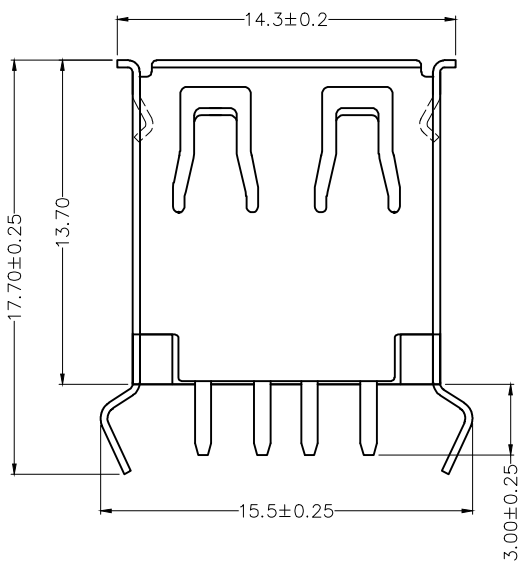
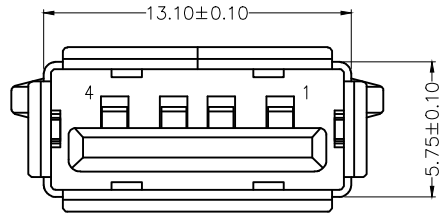

Recommended P.C.Board Layout

**Pin assignment**

Circuits	Signal name
1	VBUS
2	D-
3	D+
4	GND

<p>THIRD ANGLE PROJECTION</p>	GENERAL TOLERANCES (UNLESS SPECIFIED)		APPROVE BY FRANK	DATE 27/MAY/20	PART NO. FUS282-FDSWHK	ITEM NO. FUS282	<p>Leader Of Industry</p>	
	X.X ±0.30	X.* ±5°	CHECKED BY CHERRY	DATE 27/MAY/20	TITLE USB A-type 4Circuits 180°Vertical Female(DIP)			
DESIGN UNITS Metric	X.XX ±0.15	X.XX* ±1°	DRAWN BY KATE	DATE 27/MAY/20	THIS DRAWING CONTAINS INFORMATION THAT IS PROPRIETARY TO TXGA INDUSTRIAL ELECTRONICS(S.Z)CO.,LTD AND SHOULD NOT BE USED WITHOUT WRITTEN PERMISSION		REV 0	SHEET NO. 1/1
SCALE 5:1	SIZE A4	X.XXX ±0.10	X.XXX* ±0.5°					

1 2 3 4 5 6 7 8