

Pin assignment

Circuits	Signal name
1	VBUS
2	D-
3	D+
4	GND

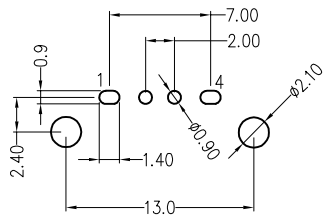
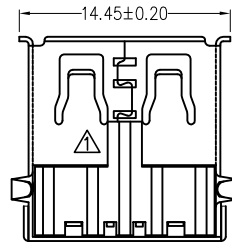
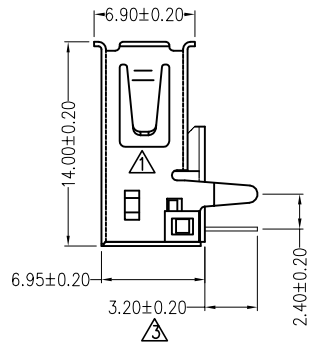
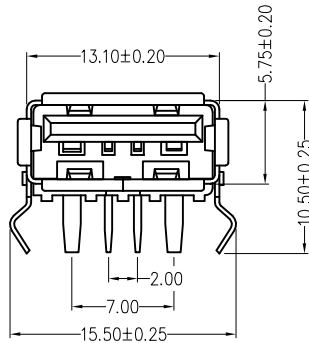

Recommended P.C.Board Layout
General tolerances: ±0.05mm

REV	LOCATIONS	DESCRIPTION	DATE	REVISER	APPD
1	△	Update the structure	24/APR/25	MATT	LEO
2	△	Update the Material of zhe housing	16/DEC/25	MATT	LEO
3	△	Update dimensions	28/FEB/26	MATT	LEO

SPECIFICATIONS

Electrical

Current Rating: 3.0A & 5.0A AC(rms)/DC
 Voltage Rating: 30V AC(rms)/DC
 Contact Resistance(Initial): 30 mΩ Max
 Withstanding Voltage: 500V AC r.m.s
 Insulation Resistance: 1000 MΩ MIN
 Temperature Range-Operating: -40°C~+85°C

Material and Plating

△ Housing: PBT (UL 94V-0) White/LCP (UL 94V-0) Black
 Contact: Copper alloy/ Gold on contact area, Tin on tail.
 Shell: Copper alloy/ Nickel Plated

Part No.	Current Rating	Material of Contact	Plating of Contact
FUS288-FDBXXKA	3.0A	C2680	0.025μm Gold plated
FUS288-FDBXXKB	5.0A	C7025	0.075μm Gold plated

Ordering Informaion

FUS 2 88 - F D B XX K X
 1 2 3 4 5 6 7 8 9

1 Category FUS-USB	2 Series Number 2-USB 2.0	3 Distinction No. 88	4 Type F-Female	5 Assembly Layout D-DIP
6 Entry Angle B-90° Angle	7 Color-Resin BK-Black WH-White	8 Packaging K-Tray	9 Material and Plating-contact A-C2680 /0.025μm Gold plated B-C7025 /0.075μm Gold plated	

 THIRD ANGLE PROJECTION	GENERAL TOLERANCES (UNLESS SPECIFIED)		APPROVE BY FRANK	DATE 25/MAY/22	PART NO. FUS288-FDBXXKX	ITEM NO. FUS288	 Building Technology Cornerstone
	X.±0.30	X.±5°	CHECKED BY CHERRY	DATE 25/MAY/22	TITLE USB A-type 4Circuits 90°Angle Female		
DESIGN UNITS Metric	X.X±0.20	.X'±2'	DRAWN BY MATT	DATE 25/MAY/22	THIS DRAWING CONTAINS INFORMATION THAT IS PROPRIETARY TO TXGA INDUSTRIAL ELECTRONICS(S.Z)CO.,LTD AND SHOULD NOT BE USED WITHOUT WRITTEN PERMISSION		
SCALE 5:1	SIZE A4	X.XX±0.15	.XX'±1'				
		X.XXX±0.10	.XXX'±0.5'				