

REV	LOCATIONS	DESCRIPTION	DATE	REVISER	APPD
1	▲	Size & Structure change	05/JAN/22	MATT	CHERRY
2	▲	Size & Structure change	27/MAY/24	MATT	CHERRY

**Electrical**

Current Rating: 1.8A AC(rms)/DC  
Voltage Rating: 30V AC(rms)/DC  
Contact Resistance: 30 mΩ Max  
Insulation Resistance: 100 MΩ MIN  
Withstanding Voltage: 100V AC r.m.s  
Temperature Range—Operating: -55°C ~ +85°C

**Mechanical**

Insertion force: 3.57kgf Max.  
Withdrawal force: 1.02kgf Min.

**Material and Plating**

Housing: PBT( UL 94V-0) Blue  
Contact Pin: Copper Alloy  
Plating: Selective gold 0.025um in contact area, Tin on tail.

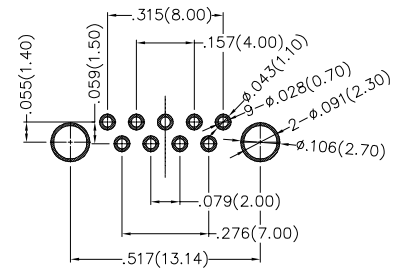
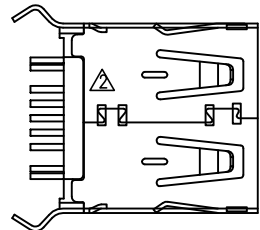
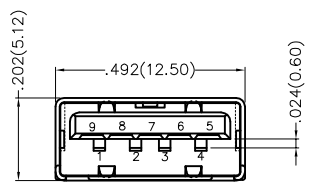
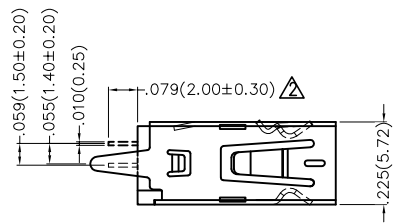
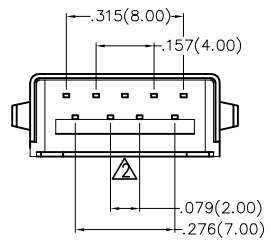
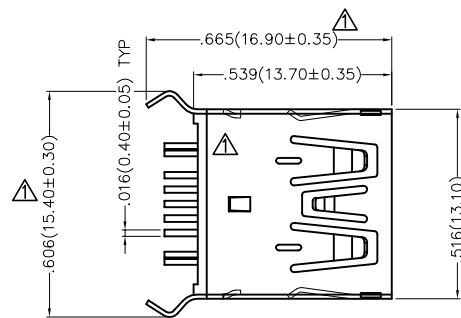

Recommended P.C.Board Layout

Circuits	Signal name
1	VBUS
2	D-
3	D+
4	GND
5	StdA_SSRX-
6	StdA_SSRX+
7	GND_DRAIN
8	StdA_SSTX-
9	StdA_SSTX+
Shell	Shield

 THIRD ANGLE PROJECTION	GENERAL TOLERANCES (UNLESS SPECIFIED)		APPROVE BY FRANK	DATE 18/JUN/13	PART NO. FUS320-FDBU1K	ITEM NO. FUS320	 Building Technology Cornerstone
	DESIGN UNITS Inch (metric)	X.±.012(0.30) X.±5'	CHECKED BY CHERRY	DATE 18/JUN/13	TITLE USB A-type 9Circuits 180°Vertical Female(DIP)(3.0)		
SCALE 5:1	SIZE A4	X.XX±.006(0.15) .XX'±1'	DRAWN BY KATE	DATE 18/JUN/13	THIS DRAWING CONTAINS INFORMATION THAT IS PROPRIETARY TO TXGA INDUSTRIAL ELECTRONICS(S.Z)CO.,LTD AND SHOULD NOT BE USED WITHOUT WRITTEN PERMISSION		