

REV	LOCATIONS	DESCRIPTION	DATE	REVISER	APPD
1	▲	Structure change	12/SEP/19	KATE	CHERRY

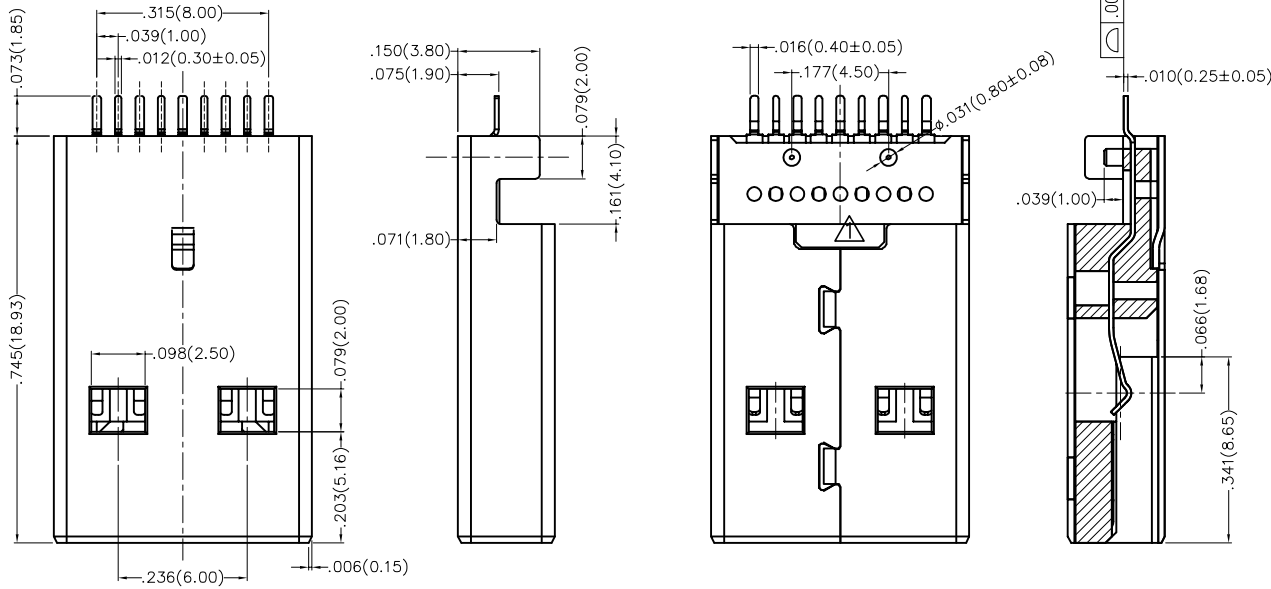

**SPECIFICATIONS**

**Electrical**

Current Rating: 1.5A AC(rms)/DC  
Voltage Rating: 30V AC(rms)/DC  
Contact Resistance: 30 mΩ Max  
Withstanding Voltage: 500V AC r.m.s  
Insulation Resistance: 1000 MΩ Min  
Temperature Range-Operating: -40°C~+85°C

**Material**

Housing: LCP (UL 94V-0) Blue  
Terminal: Phosphor Bronze  
Shell: SPCC

**Plating**

Terminal: Gold in contact area, tin on tail  
Shell: Nickel Plated

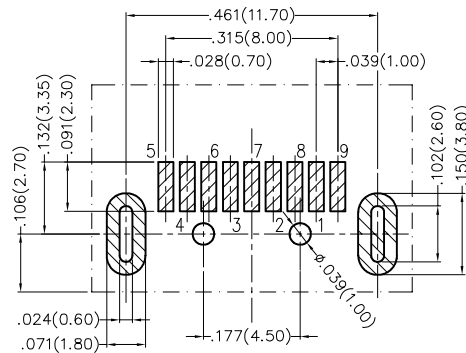
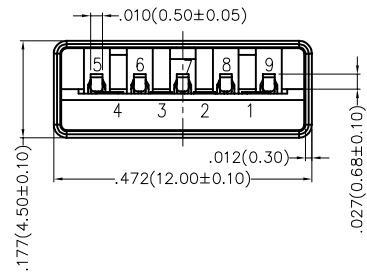

Recommended P.C.Board Layout

**Ordering Informaion**

FUS 3 22 - M S B U1 X  
1 2 3 4 5 6 7 8

1 Category FUS-USB 2 Series Number 3-USB 3.0 3 Distinction No. 22 4 Type M-Male

5 Assembly Layout S-SMT 6 Entry Angle B-90° Angle 7 Color-Resin U1-Blue 8 Packaging K-Tray M-Reel

Circuits	Signal name	Circuits	Signal name
1	VBUS	5	StdA_SSRX-
2	D-	6	StdA_SSRX+
3	D+	7	GND_DRAIN
4	GND	8	StdA_SSTX-
Shell	Shield	9	StdA_SSTX+

DESIGN UNITS	SCALE	SIZE	GENERAL TOLERANCES (UNLESS SPECIFIED)	APPROVE BY	DATE	PART NO.	ITEM NO.
Inch (metric)	5:1	A4	X.±.012(0.30) X.±5°	FRANK	13/MAR/17	FUS322-MSBU1X	FUS322
			X.X±.008(0.20) X.±2°	CHECKED BY	DATE	TITLE	
			X.XX±.006(0.15) X.X±1°	CHERRY	13/MAR/17	USB A-type	
			X.XXX±.004(0.10) X.XX±0.5°	DRAWN BY	DATE	9Circuits 90°Angle Male(SMT)(3.0)	REV 1 SHEET NO. 1/1
				KATE	13/MAR/17	THIS DRAWING CONTAINS INFORMATION THAT IS PROPRIETARY TO TXGA INDUSTRIAL ELECTRONICS(S.Z)CO.,LTD AND SHOULD NOT BE USED WITHOUT WRITTEN PERMISSION	

