

1 2 3 4 5 6 7 8

REV	LOCATIONS	DESCRIPTION	DATE	REVISER	APPD

A
B
C
D
E
F

A
B
C
D
E
F

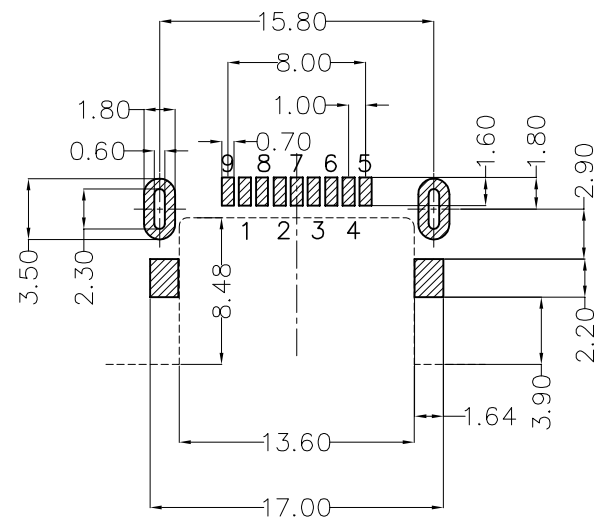
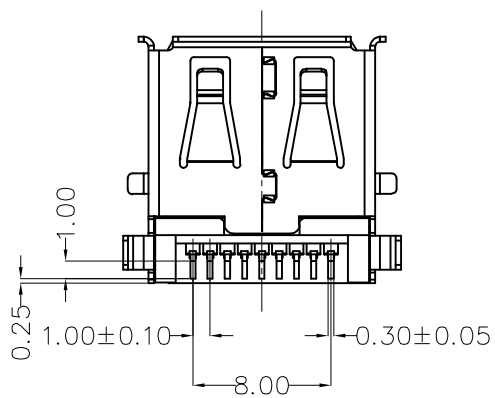

Recommended P.C.Board Layout
General tolerances ±0.05mm

SPECIFICATIONS

Electrical
 Current Rating: 1.5A AC(rms)/DC
 Voltage Rating: 40V AC(rms)/DC
 Contact Resistance: 30 mΩ Max
 Insulation Resistance: 1000 MΩ Max
 Withstanding Voltage: 500V AC r.m.s
 Operating Temperature: -40°C~+85°C

Mechanical Characteristics
 Insertion Force: 35.7N Max
 Withdraw Force: 10.2N Min
 Durability: 1500 Cycles

Material And Plating
 Housing: LCP (UL 94V-0) Blue
 Contact: Phosphor Bronze/Gold on contact area, tin on tail
 Shell: Brass/Nickel Plated

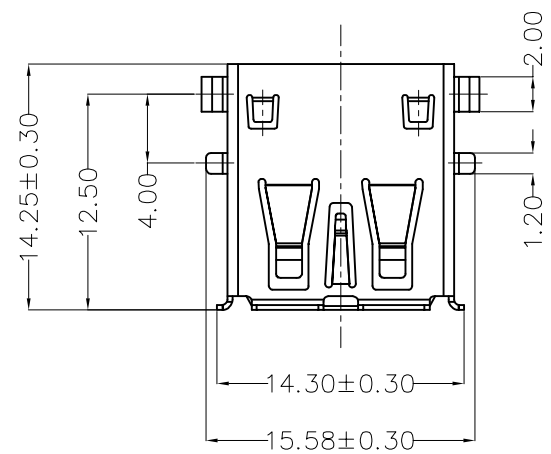
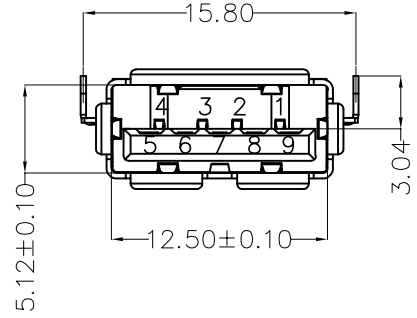
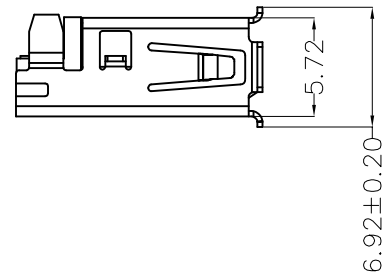
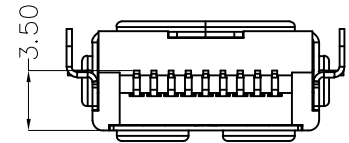

<p>THIRD ANGLE PROJECTION</p>	GENERAL TOLERANCES (UNLESS SPECIFIED)		APPROVE BY LEO	DATE 30/JAN/23	PART NO. FUS324-FSBU1K	ITEM NO. FUS324	<p>Building Technology Cornerstone</p>	
	X. ±0.30	X.* ±5°	CHECKED BY GISELLE	DATE 30/JAN/23	TITLE USB A-type 9Circuits 90°Angle Female(SMT)(3.0)			REV 0
	DESIGN UNITS METRIC	X.X ±0.20	X.X* ±2°	DRAWN BY YYQ	DATE 30/JAN/23	THIS DRAWING CONTAINS INFORMATION THAT IS PROPRIETARY TO TXGA INDUSTRIAL ELECTRONICS(S.Z)CO.,LTD AND SHOULD NOT BE USED WITHOUT WRITTEN PERMISSION		SHEET NO. 1/1
	SCALE 5:1	SIZE A4	X.XX ±0.15	X.XX* ±1°	X.XXX ±0.10	X.XXX* ±0.5°		

1 2 3 4 5 6 7 8