

REV	LOCATIONS	DESCRIPTION	DATE	REVISER	APPD

SPECIFICATIONS

Electrical
 Current Rating:
 Pin1&Pin4: 1.8A AC(rms)/DC
 Other contacts: 0.25A AC(rms)/DC
 Voltage Rating: 30V AC(rms)/DC
 Contact Resistance:
 Pin1&Pin4: 30mΩ Max
 Other contacts: 50mΩ Max
 Withstanding Voltage: 100V AC r.m.s
 Insulation Resistance: 100 MΩ Min
 Temperature Range-Operating: -55°C~+85°C

Mechanical
 Insertion force: 35N Max.
 Withdrawal force: 10N Min.
 8N Min after durability
 Durability: 5,000 cycles

Material
 Housing:
 USB3.0: PBT (UL 94V-0) Blue
 USB2.0: PBT (UL 94V-0) Blue
 Terminal: Copper Alloy
 Shell: Brass

Plating
 Terminal: Gold on contact area, tin on tail
 Shell: Nickel Plated

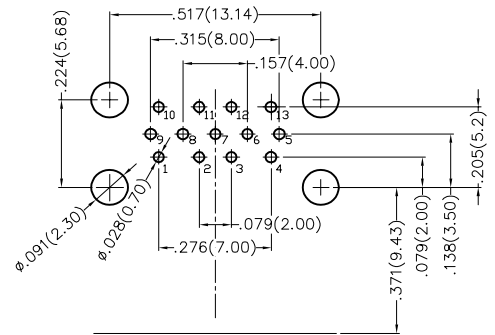

Recommended P.C.Board Layout
 General tolerances: ±0.05mm

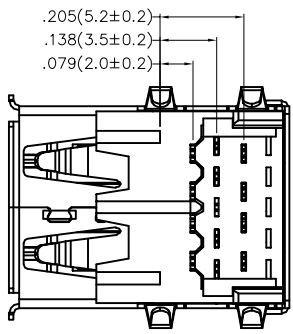
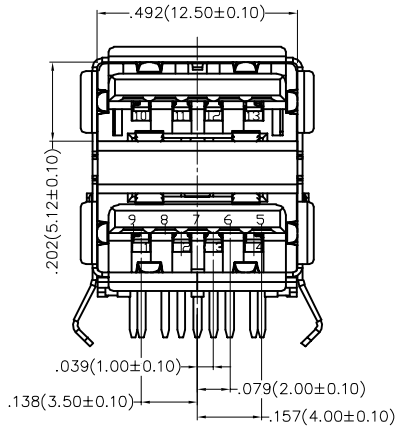
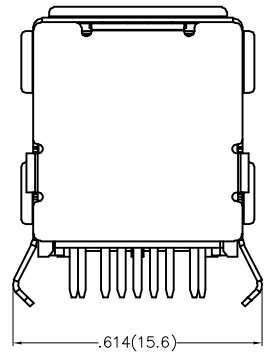
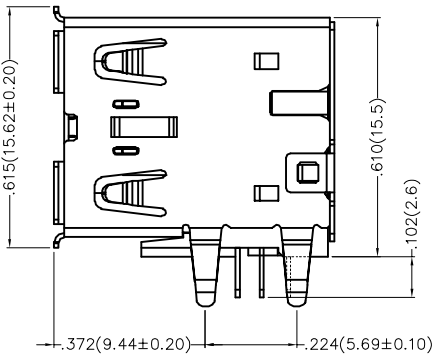
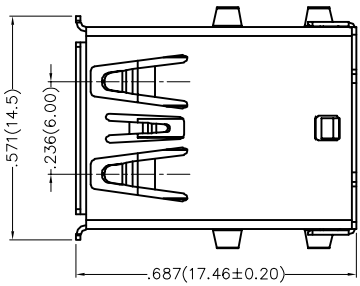

Pin Define Table:

PIN NO.	1&10	2&11	3&12	4&13	
SIGNAL NAME	VBUS	D-	D+	GND	
PIN NO.	5	6	7	8	9
SIGNAL NAME	StdA_SSRX-	StdA_SSRX+	GND-DRAIN	StdA_SSTX-	StdA_SSTX+

 THIRD ANGLE PROJECTION	GENERAL TOLERANCES (UNLESS SPECIFIED)		APPROVE BY FRANK	DATE 13/MAR/18	PART NO. FUS326-FDBU1K	ITEM NO. FUS326	
	X.±.012(0.30)	X.±5'	CHECKED BY CHERRY	DATE 13/MAR/18	TITLE USB A-type		
	X.X±.008(0.20)	.X'±2'	DRAWN BY KATE	DATE 13/MAR/18	9+4Circuits 90°Angle Female(DIP)(3.0)		
	X.XX±.006(0.15)	.XX'±1'	THIS DRAWING CONTAINS INFORMATION THAT IS PROPRIETARY TO TXGA INDUSTRIAL ELECTRONICS(S.Z)CO.,LTD AND SHOULD NOT BE USED WITHOUT WRITTEN PERMISSION				
SCALE 5:1	SIZE A4	X.XXX±.004(0.10)	.XXX'±0.5'	REV 0			SHEET NO. 1/1



THIS DRAWING CONTAINS INFORMATION THAT IS PROPRIETARY TO TXGA INDUSTRIAL ELECTRONICS(S.Z)CO.,LTD AND SHOULD NOT BE USED WITHOUT WRITTEN PERMISSION