

REV	LOCATIONS	DESCRIPTION	DATE	REVISOR	APPD
1	▲	Size change	29/OCT/20	KATE	CHERRY

**SPECIFICATIONS**

**Electrical**  
 Current Rating: 1A Max AC(rms)/DC  
 Voltage Rating: 30V AC(rms)/DC  
 Contact Resistance: 30 mΩ Max  
 Withstanding Voltage: 100V AC r.m.s  
 Insulation Resistance: 100 MΩ Min  
 Temperature Range-Operating: -30°C~+80°C

**Mechanical**  
 Insertion Force: 3.57kgf Max  
 Withdrawal Force: 1.0kgf Min

**Material And Plating**  
 Housing: Thermoplastic UL94V-0, Black  
 Contact: Copper Alloy T=0.15mm/Gold Plated  
 Shell: SUS304 T=0.3mm /Nickel Plated

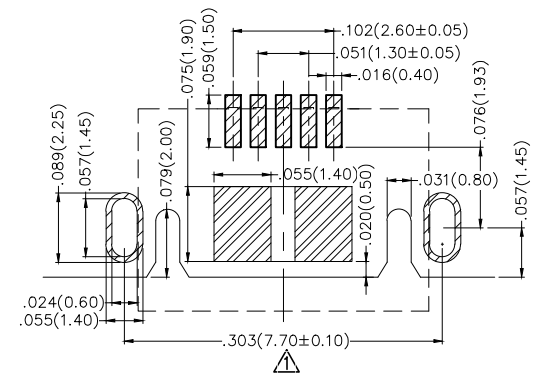
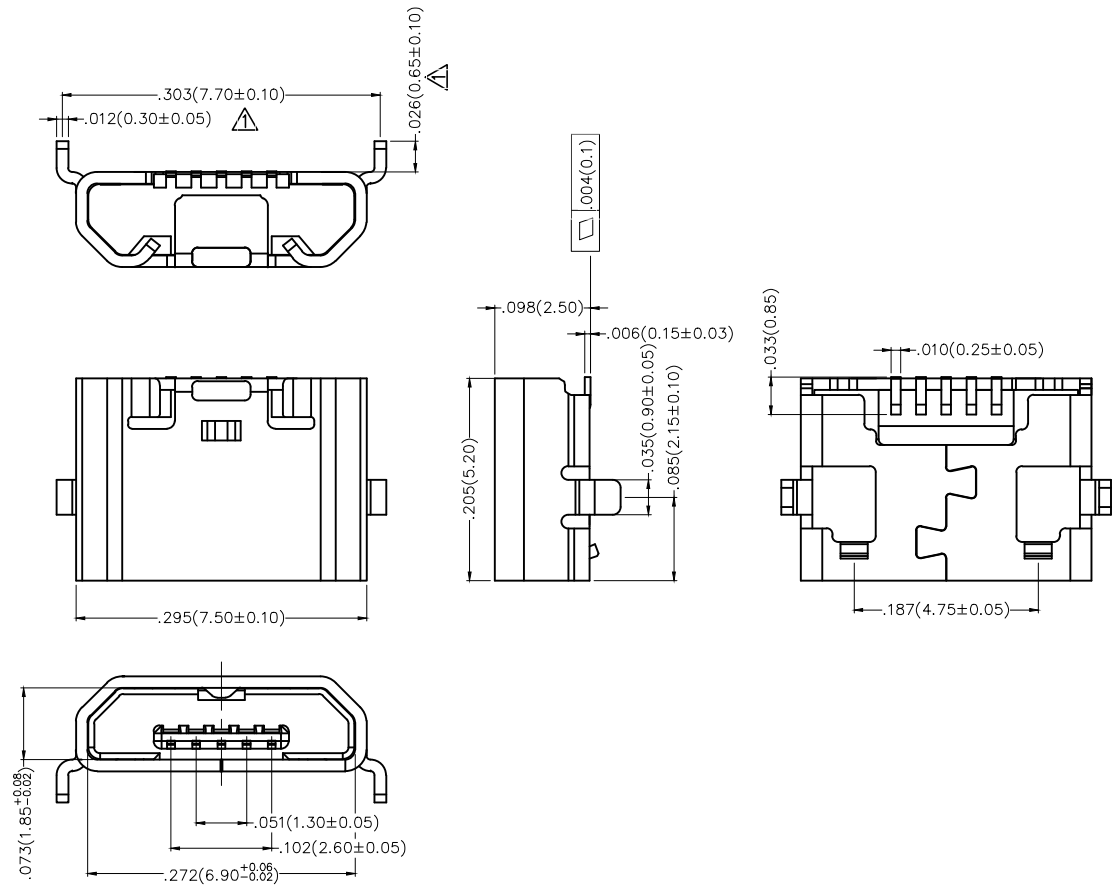

<p>THIRD ANGLE PROJECTION</p>	GENERAL TOLERANCES (UNLESS SPECIFIED)		APPROVE BY FRANK	DATE 20/MAR/17	PART NO. FUS445-FSBK6M	ITEM NO. FUS445	<p>Leader Of Industry</p>
	X.X±.012(0.30)	X.'±5'	CHECKED BY CHERRY	DATE 20/MAR/17	TITLE Micro USB 5Circuits 90°Angle Female(SMT)		
	X.X±.008(0.20)	.X'±2'	DRAWN BY KATE	DATE 20/MAR/17	THIS DRAWING CONTAINS INFORMATION THAT IS PROPRIETARY TO TXGA INDUSTRIAL ELECTRONICS(S.Z)CO.,LTD AND SHOULD NOT BE USED WITHOUT WRITTEN PERMISSION		SHEET NO. 1/1
	X.XX±.006(0.15)	.XX'±1'					
SCALE 5:1	SIZE A4	X.XXX±.004(0.10)	.XXX'±0.5'				