

REV	LOCATIONS	DESCRIPTION	DATE	REVISER	APPD

SPECIFICATIONS

Electrical
 Current Rating: 1A Max AC(rms)/DC
 Voltage Rating: 30V AC(rms)/DC
 Contact Resistance: 30 mΩ Max
 Withstanding Voltage: 500V AC r.m.s
 Insulation Resistance: 500 MΩ Min
 Temperature Range—Operating: -20°C~+60°C

Material And Plating
 Housing: Thermoplastic UL94V-0, Black
 Contact: Phosphor bronze /Gold Plated
 Shell: Brass /Nickel Plated

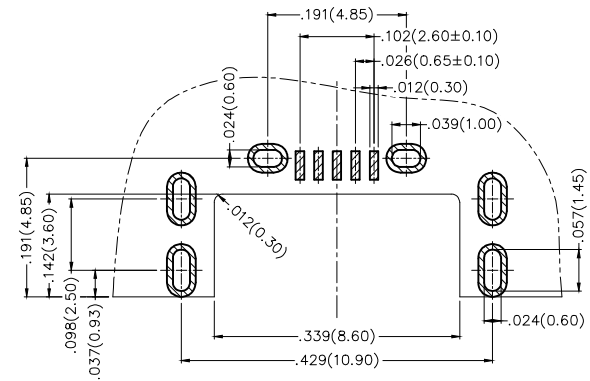
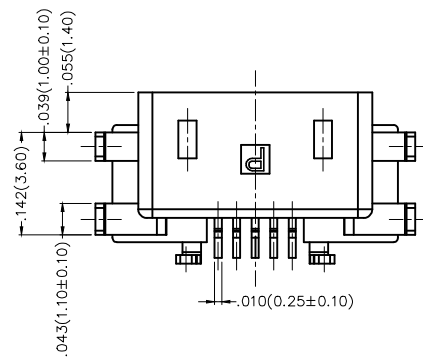
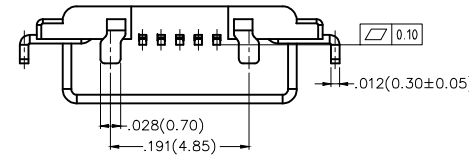
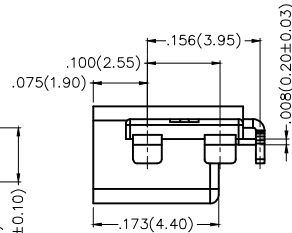
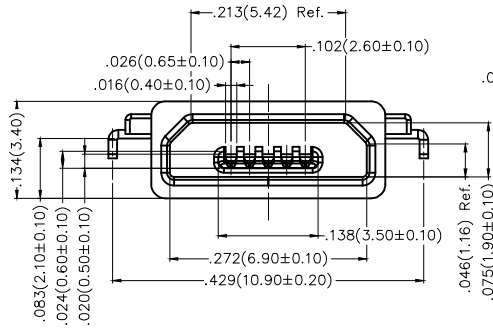
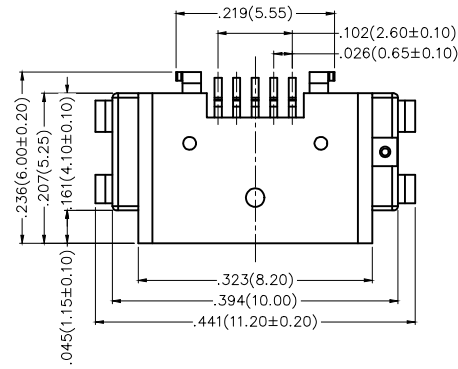

Recommended P.C.Board Layout
 General Tolerances: ±0.05mm

 THIRD ANGLE PROJECTION	GENERAL TOLERANCES (UNLESS SPECIFIED)		APPROVE BY	DATE	PART NO.	ITEM NO.	 Leader Of Industry	
	X.±.012(0.30)	X'.±5'	FRANK	13/FEB/17	FUS446-FSBK6M	FUS446		
DESIGN UNITS	X.X±.008(0.20)	.X'±2'	CHECKED BY	DATE	TITLE		REV 0	SHEET NO. 1/1
Inch (metric)	X.XX±.006(0.15)	.XX'±1'	CHERRY	13/FEB/17	Micro USB 5Circuits 90°Angle Female(SMT)			
SCALE	X.XXX±.004(0.10)	.XXX'±0.5'	DRAWN BY	DATE	THIS DRAWING CONTAINS INFORMATION THAT IS PROPRIETARY TO TXGA INDUSTRIAL ELECTRONICS(S.Z)CO.,LTD AND SHOULD NOT BE USED WITHOUT WRITTEN PERMISSION			
5:1			KATE	13/FEB/17				