

REV	LOCATIONS	DESCRIPTION	DATE	REVISER	APPD

**SPECIFICATIONS**

**Electrical**  
 Current Rating: 1.8A Max(Pin1,5)  
                   1.0A Max(Pin2,3,4)  
 Voltage Rating: 30V AC(rms)/DC  
 Contact Resistance: 30 mΩ Max  
 Withstanding Voltage: 100V AC r.m.s  
 Insulation Resistance: 100 MΩ Min  
 Temperature Range—Operating: -30°C~+80°C

**Mechanical**  
 Insertion Force: 3.57kgf Max  
 Withdrawal Force: 1.0kgf Min

**Material And Plating**  
 Housing: LCP (UL94V-0), Black  
 Contact: Copper Alloy /Gold Plated  
 Shell: Copper Alloy /Matte tin Plated

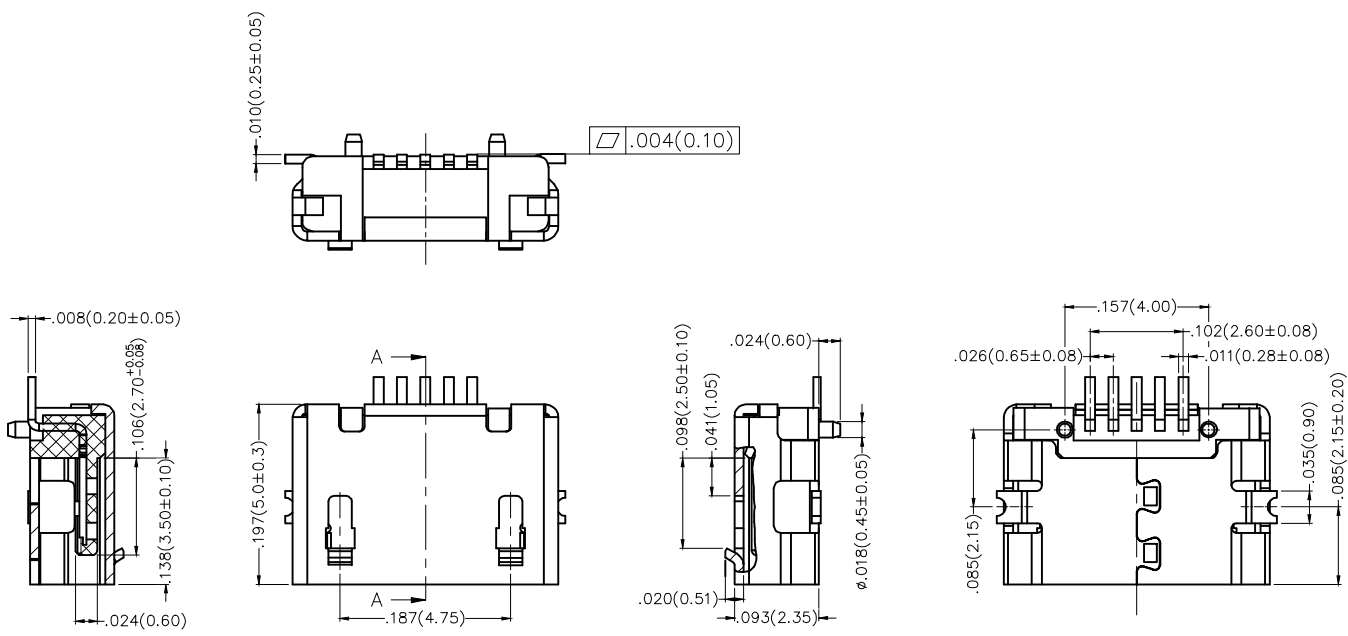

**Section A-A**

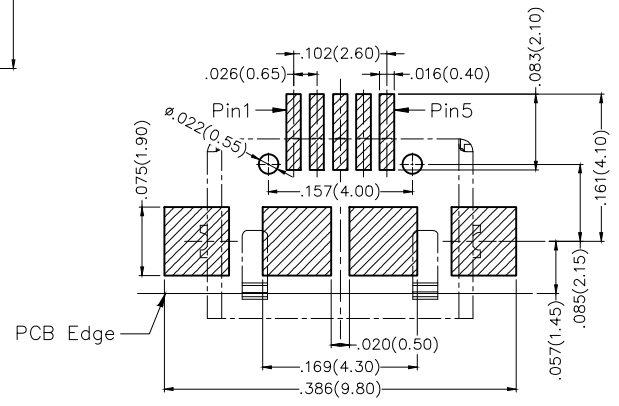
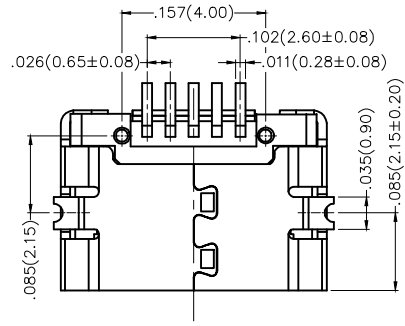
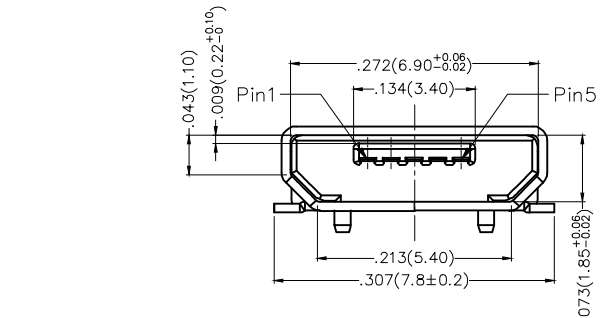

**Recommended P.C.Board Layout**  
 General Tolerances: ±.002(0.05)

**Pinassignment:**

Pins	1	2	3	4	5
Signal name	VBUS	D-	D+	ID	GND

<p>THIRD ANGLE PROJECTION</p>	GENERAL TOLERANCES (UNLESS SPECIFIED)		APPROVE BY	DATE	PART NO.	ITEM NO.	<p>Leader Of Industry</p>
	X.±.012(0.30)	X.±5'	FRANK	16/AUG/18	FUS479-FSBK6M	FUS479	
	X.X±.008(0.20)	X.±2'	CHECKED BY	DATE	TITLE		
	X.XX±.006(0.15)	.XX±1'	CHERRY	16/AUG/18	Micro USB 5Circuits 90°Angle Female(SMT)		
SCALE	SIZE	X.XXX±.004(0.10)	.XXX±0.5'	DRAWN BY	DATE	THIS DRAWING CONTAINS INFORMATION THAT IS PROPRIETARY TO TXGA INDUSTRIAL ELECTRONICS(S.Z)CO.,LTD AND SHOULD NOT BE USED WITHOUT WRITTEN PERMISSION	
5:1	A4			KATE	16/AUG/18	REV 0	SHEET NO. 1/1