

1 2 3 4 5 6 7 8

REV	LOCATIONS	DESCRIPTION	DATE	REVISER	APPD

**SPECIFICATIONS**

**Electrical**  
 Current Rating: 1.8A Max(Pin1,5)  
 1.0A Max(Pin2,3,4)  
 Voltage Rating: 30V AC(rms)/DC  
 Contact Resistance: 30 mΩ Max  
 Withstanding Voltage: 100V AC r.m.s  
 Insulation Resistance: 100 MΩ Min  
 Temperature Range—Operating: -30°C~+80°C

**Mechanical**  
 Insertion Force: 3.57kgf Max  
 Withdrawal Force: 1.0kgf Min

**Material And Plating**  
 Housing: Thermoplastic (UL94V-0), Black  
 Contact: Copper Alloy /Gold Plated  
 Shell: SUS304 /Nickel Plated

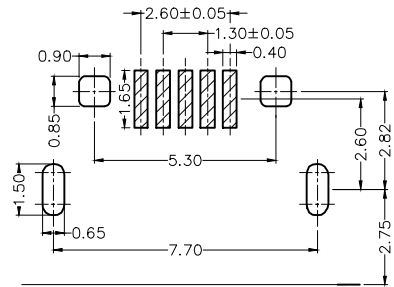
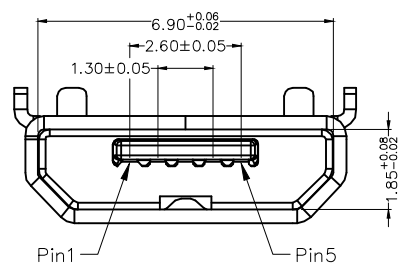
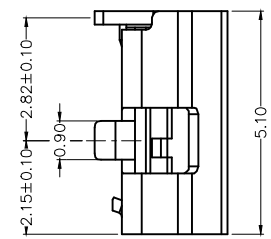
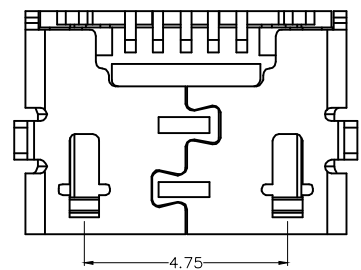
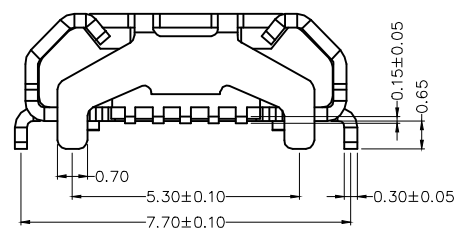

Pinassignment:

Pins	1	2	3	4	5
Signal name	VBUS	D-	D+	ID	GND

Recommended P.C.Board Layout  
 General Tolerances: ±.002(0.05)

A  
B  
C  
D  
E  
F

A  
B  
C  
D  
E  
F

<p>THIRD ANGLE PROJECTION</p>	GENERAL TOLERANCES (UNLESS SPECIFIED)		APPROVE BY FRANK	DATE 24/JUN/20	PART NO. FUS481-FSBBKM	ITEM NO. FUS481	<p>Leader Of Industry</p>
	DESIGN UNITS Metric	X. ±0.30 X.X ±0.20 X.XX ±0.15 X.XXX ±0.10	X.* ±5° X.X* ±2° X.XX* ±1° X.XXX* ±0.5°	CHECKED BY CHERRY	DATE 24/JUN/20	TITLE Micro USB 5Circuits 90°Angle Female(SMT)	
SCALE 5:1	SIZE A4		DRAWN BY KATE	DATE 24/JUN/20	THIS DRAWING CONTAINS INFORMATION THAT IS PROPRIETARY TO TXGA INDUSTRIAL ELECTRONICS(S.Z)CO.,LTD AND SHOULD NOT BE USED WITHOUT WRITTEN PERMISSION		REV 0 SHEET NO. 1/1

1 2 3 4 5 6 7 8