

REV	LOCATIONS	DESCRIPTION	DATE	REVISER	APPD
1	▲	Structural changes	05/FEB/21	KATE	CHERRY

SPECIFICATIONS

Electrical
 Current Rating: 3.0A AC(rms)/DC
 Voltage Rating: 100V AC(rms)/DC
 Contact Resistance: 40 mΩ Max
 Withstanding Voltage: 500V AC r.m.s
 Insulation Resistance: 100 MΩ Min
 Temperature Range-Operating: -30°C~+85°C

Mechanical
 Insertion Force: 5~20N
 Withdrawal Force: 8~20N
 Durability: 10,000 Cycles

Material and Plating
 Housing: LCP (UL 94V-0) Black
 Contact: Copper Alloy/Gold Plated
 Shielding Plate: Stainless steel/ Nickel Plated
 Shell: Stainless steel/ Nickel Plated

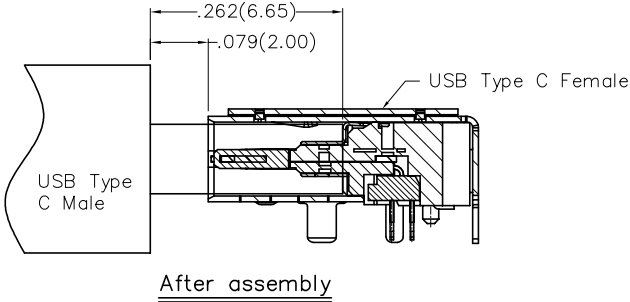
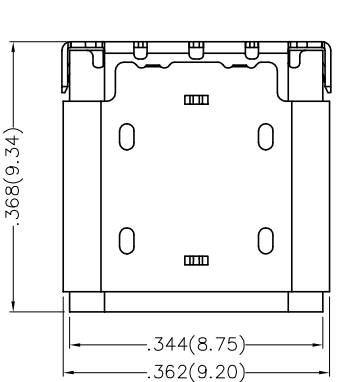

After assembly

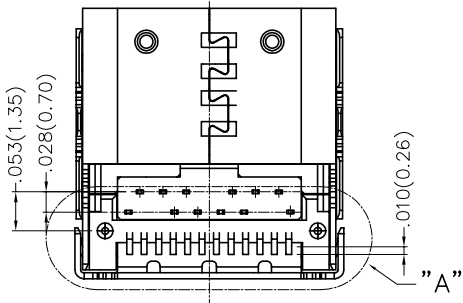
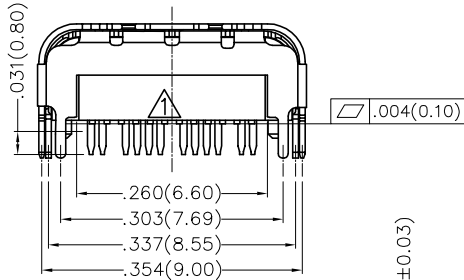
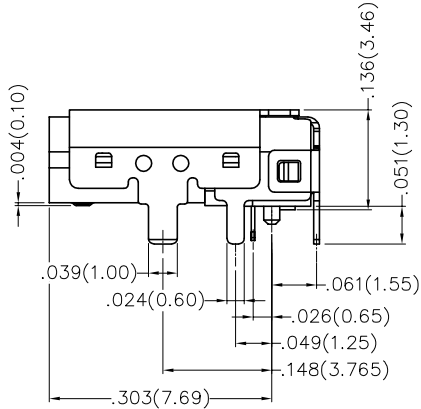
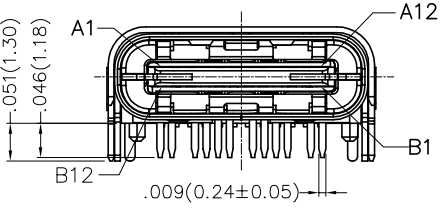

Circuits	A	Circuits	B
1	GND	12	GND
2	SSTXP1	11	SSRXP1
3	SSTXN1	10	SSRXN1
4	VBUS	9	VBUS
5	CC1	8	SBU2
6	DP1	7	DN2
7	DN1	6	DP2
8	SBU1	5	CC2
9	VBUS	4	VBUS
10	SSRXN2	3	SSTXN2
11	SSRXP2	2	SSTXP2
12	GND	1	GND

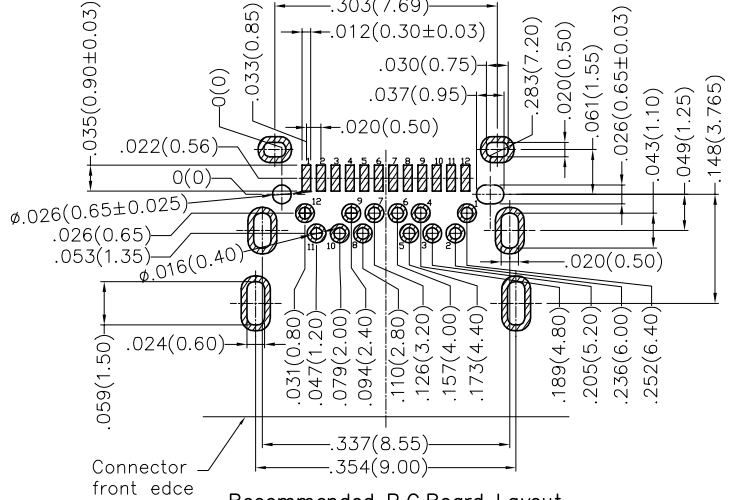

Recommended P.C.Board Layout
 General Tolerances: ±0.05mm

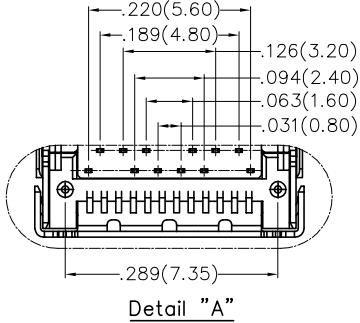

 THIRD ANGLE PROJECTION	GENERAL TOLERANCES (UNLESS SPECIFIED)		APPROVE BY	DATE	PART NO.	ITEM NO.
	X.±.012(0.30)	X.±5'	FRANK	24/APR/17		
	X.X±.008(0.20)	.X'±2"	CHECKED BY	DATE	TITLE	
	X.XX±.006(0.15)	.XX'±1"	CHERRY	24/APR/17	USB C-type 90° Angle Female(SMT+DIP)(3.1)	
SCALE	SIZE	X.XXX±.004(0.10)	.XXX'±0.5'	DRAWN BY	DATE	THIS DRAWING CONTAINS INFORMATION THAT IS PROPRIETARY TO TXGA INDUSTRIAL ELECTRONICS(S.Z)CO.,LTD AND SHOULD NOT BE USED WITHOUT WRITTEN PERMISSION
5:1	A4			LXF	24/APR/17	REV 1 SHEET NO. 1/2



REV	LOCATIONS	DESCRIPTION	DATE	REVISER	APPD

- Note:
- 1.0 sprocket hole cumulative tolerance ± 0.2
 2. Carrier camber is within 1.0mm in 250mm
 3. Material: Clear conductive polystyrene Alloy 100% recyclable
 4. All dimensions meet EIA-481-3 requirements
 5. Peel off force of cover tape & carrier tape: 20g~130g (0.2N~1.3N)
 6. Component load per 15" reel: 1,000 pcs

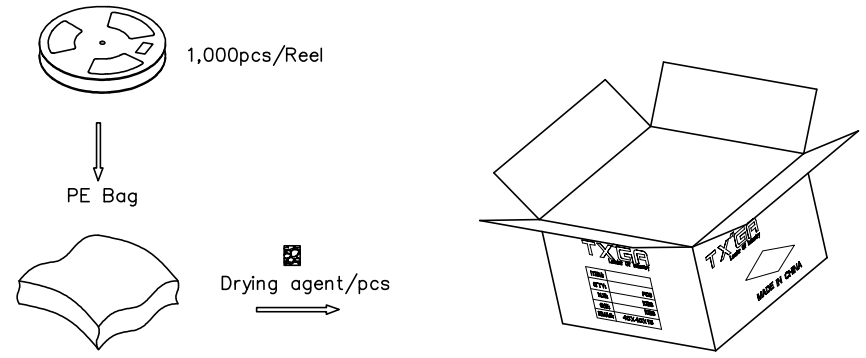
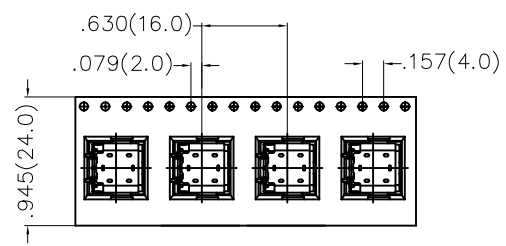
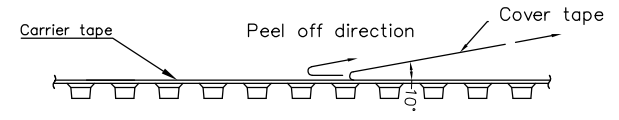
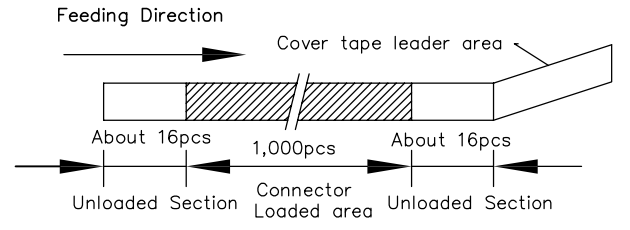
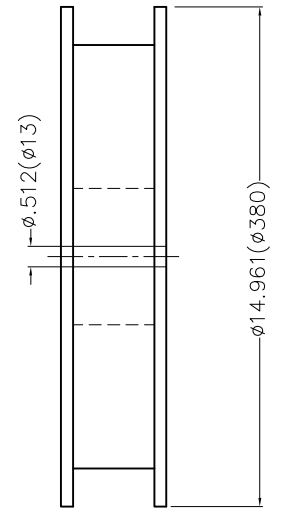
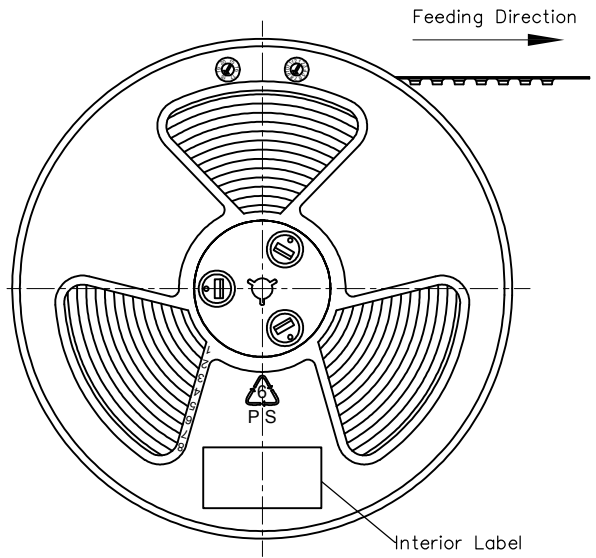

 THIRD ANGLE PROJECTION	GENERAL TOLERANCES (UNLESS SPECIFIED)		APPROVE BY	DATE	PART NO.	ITEM NO.	 Leader Of Industry
	X.±.012(0.30)	X.'±5'	FRANK	24/APR/17	FUS610-FSDBK6M	FUS610	
DESIGN UNITS Inch (metric)	X.X±.008(0.20)	.X'±2"	CHECKED BY	DATE	TITLE		REV 1
	X.XX±.006(0.15)	.XX'±1"	CHERRY	24/APR/17	USB C-type 90° Angle Female(SMT+DIP)(3.1)		
SCALE	SIZE	X.XXX±.004(0.10)	DRAWN BY	DATE	THIS DRAWING CONTAINS INFORMATION THAT IS PROPRIETARY TO TXGA INDUSTRIAL ELECTRONICS(S.Z)CO.,LTD AND SHOULD NOT BE USED WITHOUT WRITTEN PERMISSION		
5:1	A4	.XXX'±0.5'	LXF	24/APR/17			