

REV	LOCATIONS	DESCRIPTION	DATE	REVISER	APPD
1	△	Change the structural and size	26/AUG/20	KATE	CHERRY

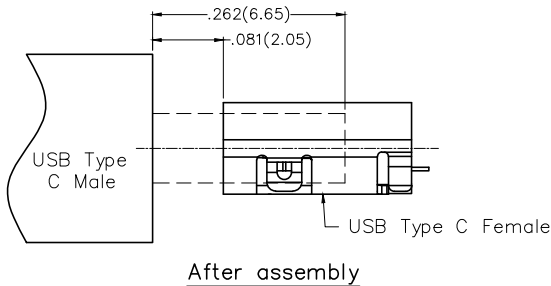
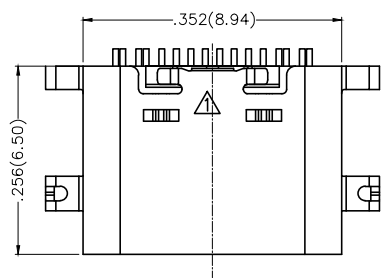

**SPECIFICATIONS**

**Electrical**  
 Current Rating: 3.0A AC(rms)/DC  
 Voltage Rating: 5V AC(rms)/DC  
 Contact Resistance: 40 mΩ Max  
 Withstanding Voltage: 100V AC r.m.s  
 Insulation Resistance: 100 MΩ Min  
 Temperature Range-Operating: -25°C~+85°C

**Mechanical**  
 Insertion Force: 5~20N  
 Withdrawal Force: 8~20N  
 Durability: 10,000 Cycles

**Material and Plating**  
 MID Plate: Stainless Steel/ Clear only  
 Shell: Stainless Steel/Nickel Plated  
 Molding: Thermoplastic (UL 94V-0)/ Black  
 Contact: Copper Alloy/ 3μ" Gold Plated  
 Housing: Thermoplastic (UL 94V-0)

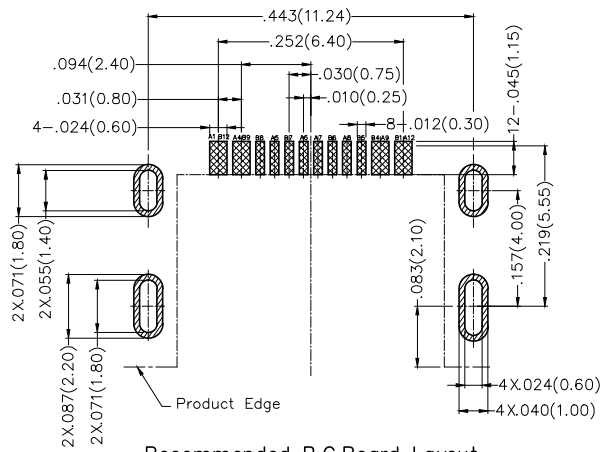
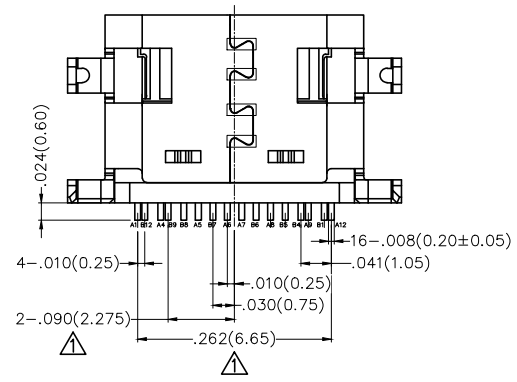
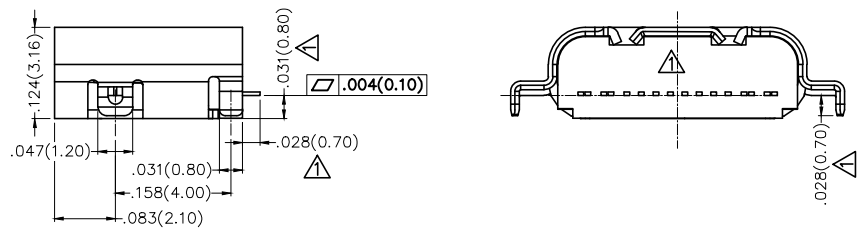
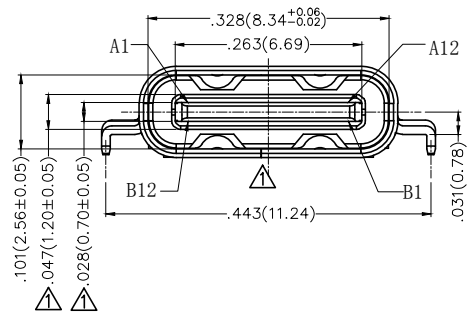

Circuits	A	Circuits	B
1	GND	12	GND
4	VBUS	9	VBUS
5	CC1	8	SBU2
6	DP1	7	DN2
7	DN1	6	DP2
8	SBU1	5	CC2
9	VBUS	4	VBUS
12	GND	1	GND

Recommended P.C.Board Layout  
 General Tolerances: ±.002(0.05)

 THIRD ANGLE PROJECTION	GENERAL TOLERANCES (UNLESS SPECIFIED)		APPROVE BY	DATE	PART NO.	ITEM NO.	 Leader Of Industry
	X.±.012(0.30)	X.±5°	FRANK	25/APR/17	FUS615-FSBK6M	FUS615	
DESIGN UNITS Inch (metric)	X.X±.008(0.20)	X.±2°	CHECKED BY	DATE	TITLE		REV 1    SHEET NO. 1/1
SCALE 5:1	X.XX±.006(0.15)	.XX±1°	CHERRY	25/APR/17	USB C-type 90° Angle Female(SMT)(3.1)		
SIZE A4	X.XXX±.004(0.10)	.XXX±0.5°	DRAWN BY	DATE	THIS DRAWING CONTAINS INFORMATION THAT IS PROPRIETARY TO TXGA INDUSTRIAL ELECTRONICS(S.Z)CO.,LTD AND SHOULD NOT BE USED WITHOUT WRITTEN PERMISSION		
			LXF	25/APR/17			