

REV	LOCATIONS	DESCRIPTION	DATE	REVISER	APPD

**SPECIFICATIONS**

**Electrical**

Current Rating: 1.5A AC(rms)/DC  
 Contact Resistanc: 30 mΩ Max  
 Insulation Resistance: 100 MΩ MIN  
 Withstanding Voltage: 500V AC r.m.s  
 Operating Temperature: -55°C ~ +105°C

**Mechanical**

Mating force: 4.0kgf Max.  
 Unmating force: 1.0kgf Min.

**Material**

Housing: PBT (UL 94V-0) Black  
 Contact: Brass/ Gold in contact area, tin on tail  
 Shell: Brass/ Nickel plated

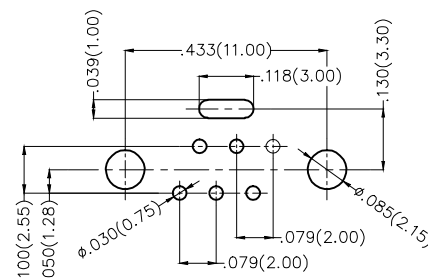
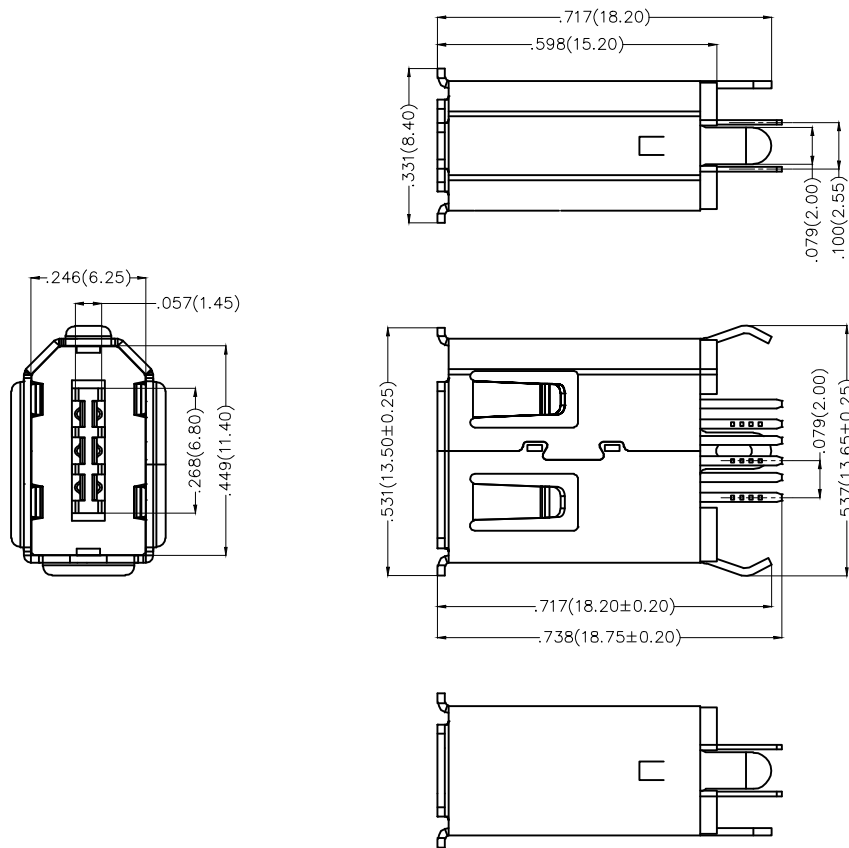

**Recommended P.C.Board Layout**  
 General tolerances: ±.002(0.05)

<p>THIRD ANGLE PROJECTION</p>	GENERAL TOLERANCES (UNLESS SPECIFIED)		APPROVE BY	DATE	PART NO.	ITEM NO.	<p>Leader Of Industry</p>
	X.±.012(0.30)	X.±5'	FRANK	09/OCT/15	FUS619-FSSK6K	FUS619	
	X.X±.008(0.20)	.X'±2'	CHECKED BY	DATE	TITLE		REV 0   SHEET NO. 1/1
	X.XX±.006(0.15)	.XX'±1'	CHERRY	09/OCT/15	IEEE 1394 6Circuits 180° Vertical Female(DIP)		
SCALE	SIZE	X.XXX±.004(0.10)	.XXX'±0.5'	DRAWN BY	DATE	THIS DRAWING CONTAINS INFORMATION THAT IS PROPRIETARY TO TXGA INDUSTRIAL ELECTRONICS(S.Z)CO.,LTD AND SHOULD NOT BE USED WITHOUT WRITTEN PERMISSION	
5:1	A4			KATE	09/OCT/15		