

REV	LOCATIONS	DESCRIPTION	DATE	REVISER	APPD
1	△	Update dimensions and tolerances	15/MAR/24	MATT	LEO

SPECIFICATIONS

Electrical

Current Rating: 3A AC(rms)/DC  
Voltage Rating: 20V AC(rms)/DC  
Contact Resistance: 40 mΩ Max  
Withstanding Voltage: 100V AC r.m.s  
Insulation Resistance: 100 MΩ Min  
Temperature Range-Operating: -30°C~+85°C

Mechanical

Insertion Force: 5~20N  
Withdrawal Force: 8~20N  
Durability: 10,000 cycles

Material and Plating

Housing: Thermoplastic (UL 94V-0) Black  
Terminal: Copper alloy/ 1μ" Gold plated in contact area, tin on tail  
Shell: Stainless steel/ Nickel plated

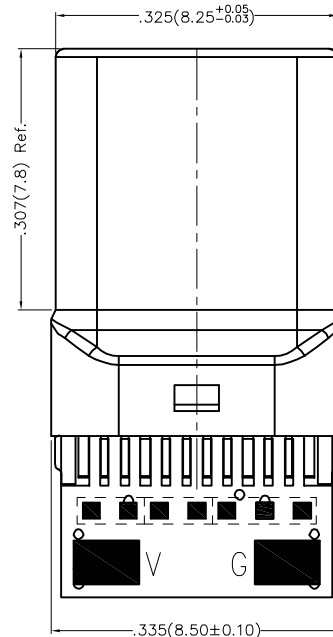
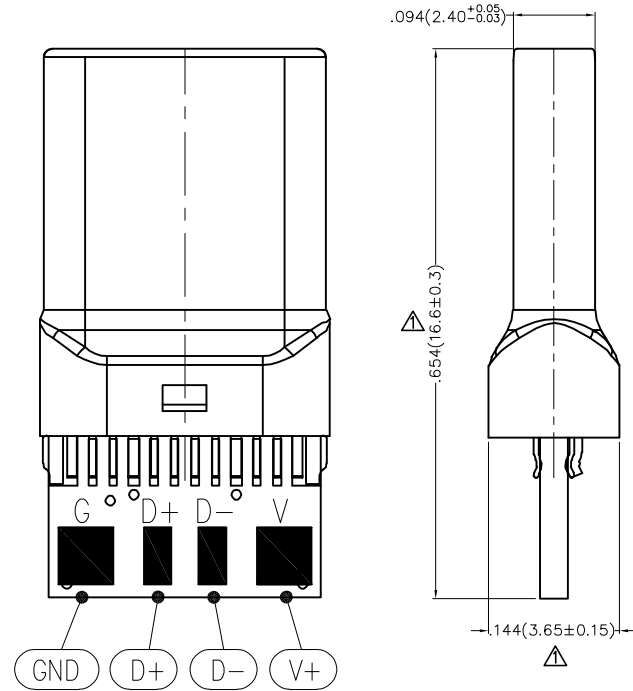
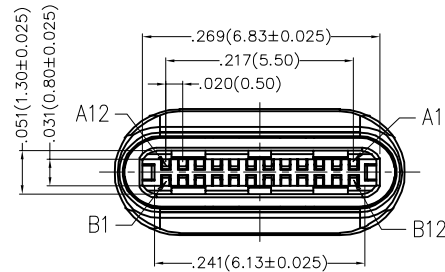

SCHEMATIC

FUS622-MWSK6LA Type C 2.0 - Resistance: 56k

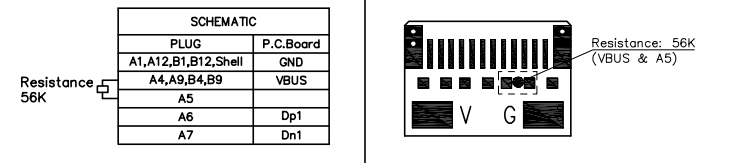

FUS622-MWSK6LB Type C 2.0 OTG

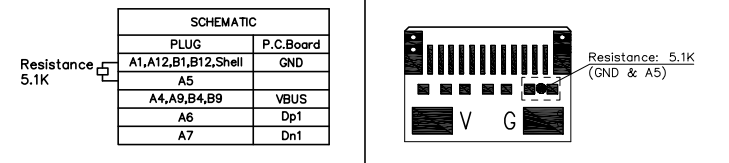

FUS622-MWSK6LC Type C 2.0 - HUAWEI Double resistance: 56k

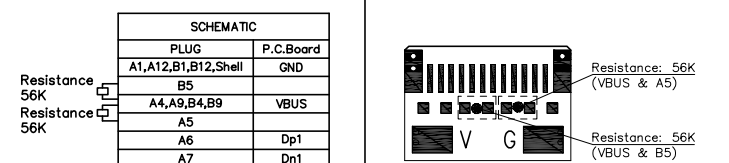

 THIRD ANGLE PROJECTION DESIGN UNITS Inch (metric) SCALE 5:1 SIZE A4	GENERAL TOLERANCES (UNLESS SPECIFIED)		APPROVE BY FRANK	DATE 06/JUL/18	PART NO. FUS622-MWSK6LX	ITEM NO. FUS622	 Leader Of Industry REV 1 SHEET NO. 1/1
	X.±.012(0.30)	X.±5'	CHECKED BY CHERRY	DATE 06/JUL/18	TITLE USB C-type 180°Vertical Male(Welding)(3.1)		
	X.X±.008(0.20)	.X'±2'	DRAWN BY KATE	DATE 06/JUL/18	THIS DRAWING CONTAINS INFORMATION THAT IS PROPRIETARY TO TXGA INDUSTRIAL ELECTRONICS(S.Z)CO.,LTD AND SHOULD NOT BE USED WITHOUT WRITTEN PERMISSION		
	X.XX±.006(0.15)	.XX'±1'					
	X.XXX±.004(0.10)	.XXX'±0.5'					