

REV	LOCATIONS	DESCRIPTION	DATE	REVISER	APPD

SPECIFICATION:

Electrical:
 Current Rating: 5A Max. for VBUS;
 Voltage Rating: 20V Max.;
 Dielectric Withstanding voltage: 100V AC;
 Contact resistance: 40 mΩ Max.;
 Insulation Resistance: 100 MΩ Min.;

Environmental:
 Operating temperature: -40°C~+85°C;
 Salt Spray Test: 48H Min.;
 Wetting Temperature: 265±5°C, 5±0.5s

Mechanical:
 Mating force: 5-20N;
 Unmating force: Initial: 8-20N; Final: 6-20N;
 Durability: 10000 Cycles;
 Shell withdrawal force: 50N MIN. (Joining Force);

Material:
 Housing: LCP (UL94-V0), White
 Shell: SUS316L, NI Plated
 Ground Bar: SUS201
 Terminal: Copper Alloy, Gold Plated 3μ"
 Latch: SUS301, Nickel Underplate, Solder Tail Area Matte Tin
 PCB: 0.80mm thickness halogen-free double-sided PCB
 R1: 56KΩ
 PTC: T45

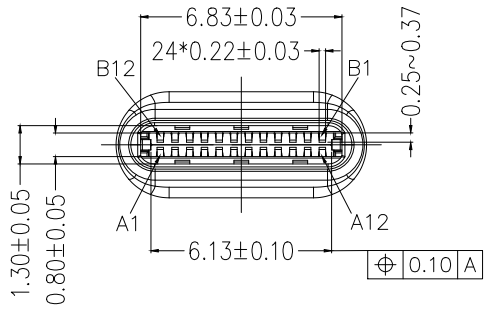
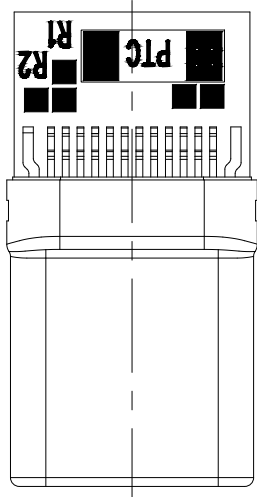
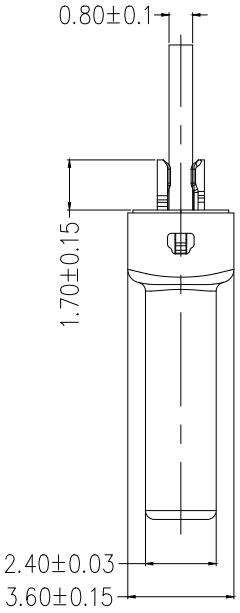
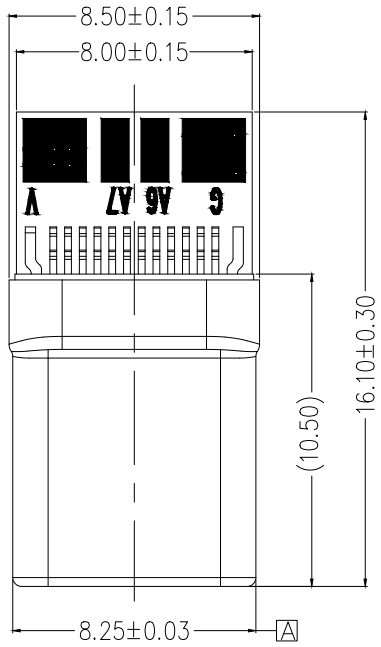

Circuits	A	B	Circuits
A1	GND	GND	B12
A2	-	-	B11
A3	-	-	B10
A4	VBUS	VBUS	B9
A5	CC1	-	B8
A6	DP1	-	B7
A7	DN1	-	B6
A8	-	-	B5
A9	VBUS	VBUS	B4
A10	-	-	B3
A11	-	-	B2
A12	GND	GND	B1

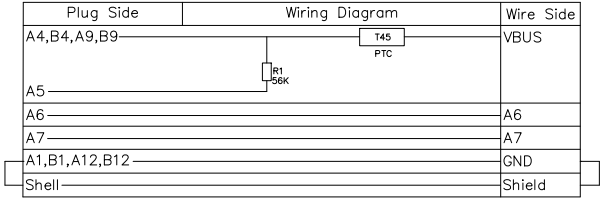

<p>THIRD ANGLE PROJECTION</p>	GENERAL TOLERANCES (UNLESS SPECIFIED)		APPROVE BY	DATE	PART NO.	ITEM NO.	<p>Building Technology Cornerstone</p>		
	X. ±0.30	X.* ±5'	LEO	28/OCT/21	FUS6222-MWSWHB	FUS6222			
	DESIGN UNITS mm		CHECKED BY	DATE	TITLE			REV 0	SHEET NO. 1/1
	X.X ±0.20	X.X' ±2'	GISELLE	28/OCT/21	USB C-type 180° Vertical Male(Welding)				
SCALE 5:1	SIZE A4	X.XX ±0.15	X.XX' ±1'	DRAWN BY	DATE	THIS DRAWING CONTAINS INFORMATION THAT IS PROPRIETARY TO TXGA INDUSTRIAL ELECTRONICS(S.Z)CO.,LTD AND SHOULD NOT BE USED WITHOUT WRITTEN PERMISSION			
		X.XXX ±0.10	X.XXX' ±0.5'	PYD	28/OCT/21				