

REV	LOCATIONS	DESCRIPTION	DATE	REVISER	APPD
1		Size & Material changes	16/JUN/22	MATT	CHERRY
2		Update Drawing	14/AUG/24	MATT	LEO

SPECIFICATIONS

Electrical

Current Rating: 1.0A AC(rms)/DC
Voltage Rating: 30V AC(rms)/DC
Contact Resistance: 20 mΩ Max
Withstanding Voltage: 500V AC r.m.s
Insulation Resistance: 1000 MΩ Min
Temperature Range—Operating: -40°C~+105°C

Mechanical

Terminal retention force: 1.6Kgf (Single pin)

Material and Plating

Housing: PBT (UL 94V-0) , Black
Terminal: Brass/ Gold plated
Iron shell: SPCC/ Nickel plated
Outside shell: ABS+PC (UL 94V-0) , Gray
Clips: S304
Lock: SPCC

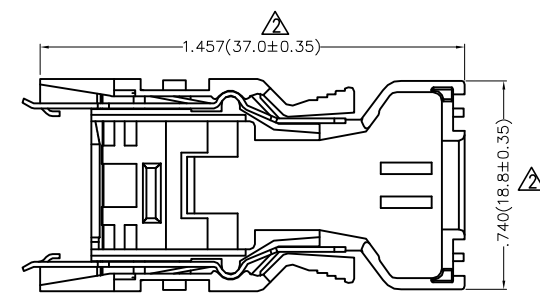
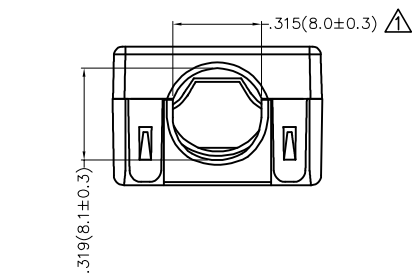
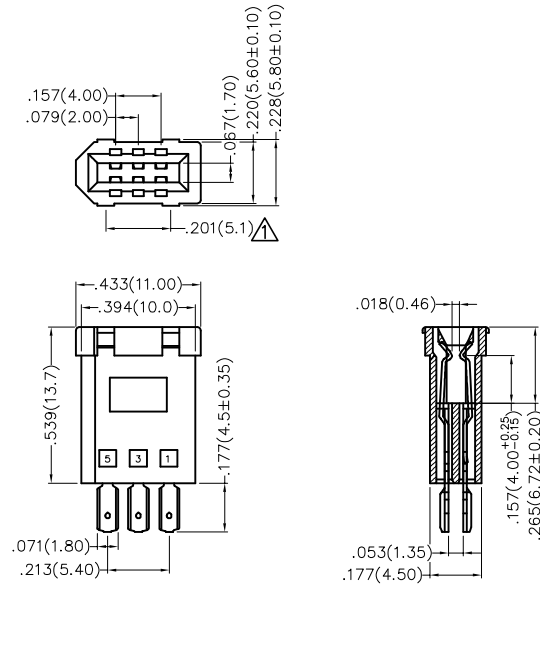
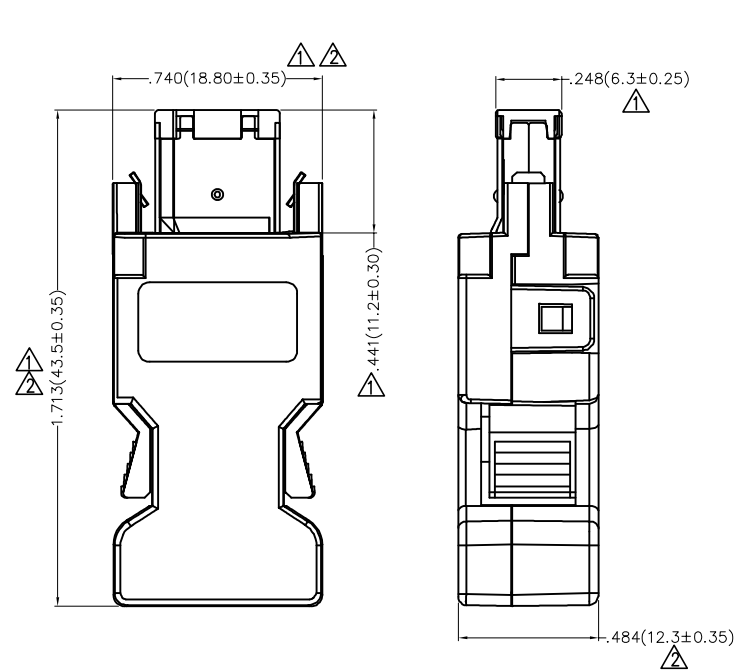

Plastic Shell

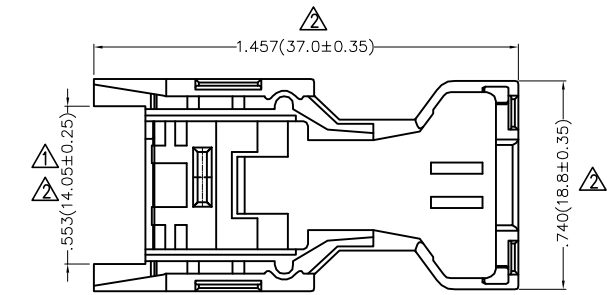

Plastic Shell

	GENERAL TOLERANCES (UNLESS SPECIFIED)		APPROVE BY	DATE	PART NO.	ITEM NO.	
	X.±.012(0.30)	X.±5'	FRANK	08/SEP/18	FUS630-MWSK6K	FUS630	
DESIGN UNITS	X.X±.008(0.20)	.X'±2"	CHECKED BY	DATE	TITLE		REV 1
Inch (metric)	X.XX±.006(0.15)	.XX'±1"	CHERRY	08/SEP/18	IEEE 1394 6Circuits 180°Vertical Male(Welding)		
SCALE	X.XXX±.004(0.10)	.XXX'±0.5'	DRAWN BY	DATE	THIS DRAWING CONTAINS INFORMATION THAT IS PROPRIETARY TO TXGA INDUSTRIAL ELECTRONICS(S.Z)CO.,LTD AND SHOULD NOT BE USED WITHOUT WRITTEN PERMISSION		
5:1			KATE	08/SEP/18			

REV	LOCATIONS	DESCRIPTION	DATE	REVISER	APPD

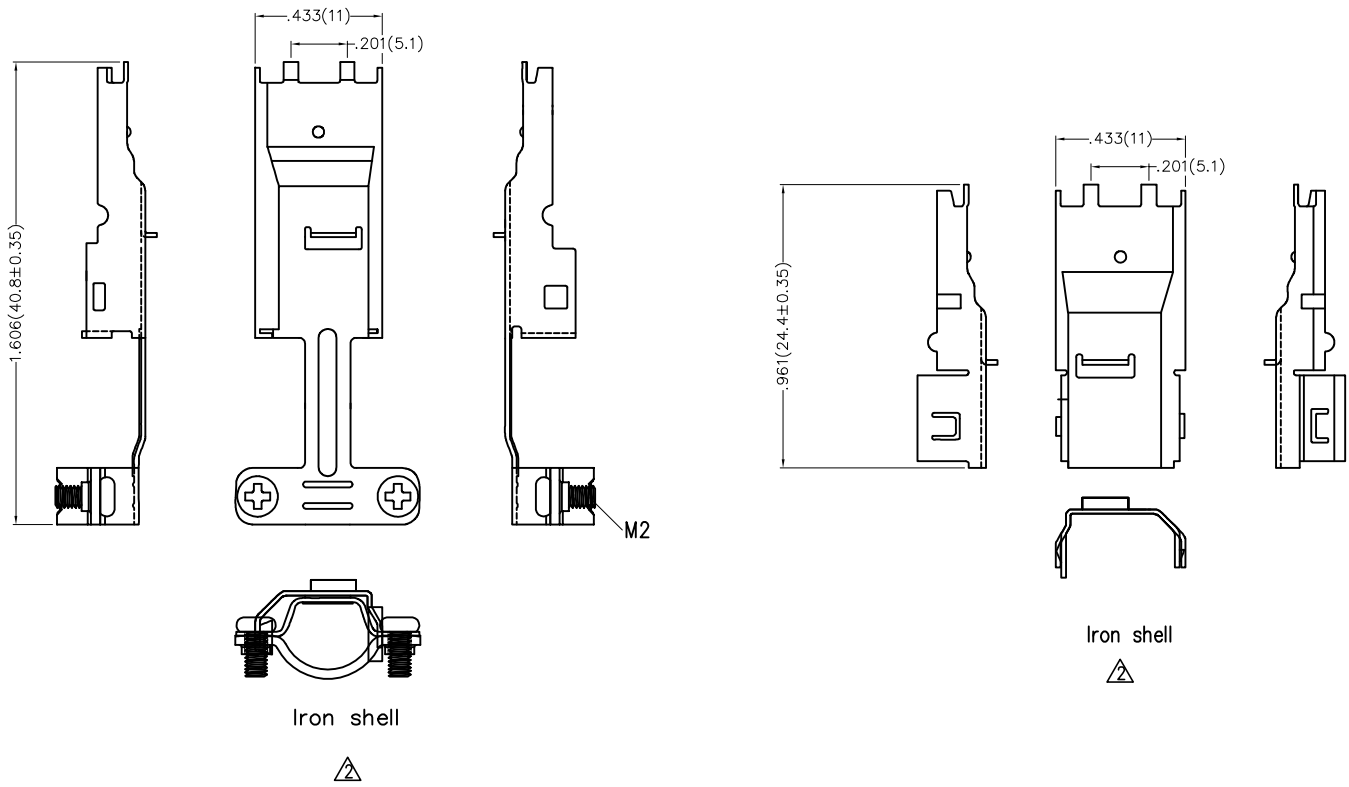

 THIRD ANGLE PROJECTION	GENERAL TOLERANCES (UNLESS SPECIFIED)		APPROVE BY	DATE	PART NO.	ITEM NO.	 Leader Of Industry
	X.±.012(0.30)	X.±5'	FRANK	08/SEP/18	FUS630-MWSK6K	FUS630	
	X.X±.008(0.20)	.X'±2"	CHECKED BY	DATE	TITLE		
	X.XX±.006(0.15)	.XX'±1"	CHERRY	08/SEP/18	IEEE 1394 6Circuits 180°Vertical Male(Welding)		
SCALE	SIZE	X.XXX±.004(0.10)	.XXX'±0.5'	DRAWN BY	DATE	THIS DRAWING CONTAINS INFORMATION THAT IS PROPRIETARY TO TXGA INDUSTRIAL ELECTRONICS(S.Z)CO.,LTD AND SHOULD NOT BE USED WITHOUT WRITTEN PERMISSION	
5:1	A4			KATE	08/SEP/18	REV 1	SHEET NO. 2/2