

REV	LOCATIONS	DESCRIPTION	DATE	REVISER	APPD

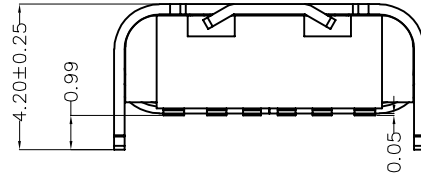
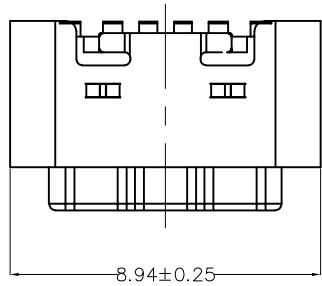

**SPECIFICATIONS**

**Electrical**

Current Rating: 3.0A AC(rms)/DC  
Voltage Rating: 5.0V AC(rms)/DC  
Contact Resistance: 50 mΩ Max  
Insulation Resistance: 100 MΩ Min  
Withstanding Voltage: 100V AC r.m.s  
Operating Temperature: -25°C~+85°C

**Mechanical**

Durability: 5000 cycles Min.  
Mating force: 0.5-2.0KG.F  
Retention force: 0.8-2.0KG.F

**Material and plating**

Housing: LCP (UL 94V-0), Black  
Contacts: Copper Alloy/Gold Plated  
Shell: Stainless steel/Nickel Plated

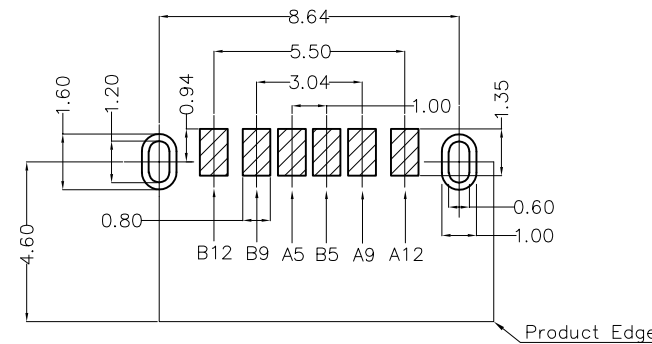
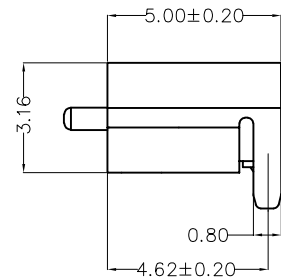
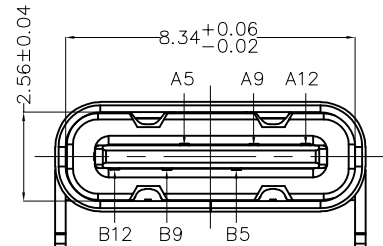

Recommended P.C.Board Layout  
General tolerances ±0.05mm

Circuits	A
A5	CC1
A9	VBUS
A12	GND
Circuits	B
B5	SBU2
B9	VBUS
B12	GND

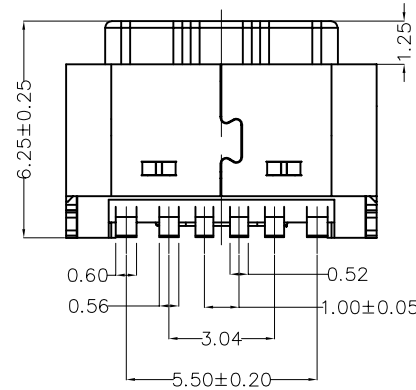

 THIRD ANGLE PROJECTION DESIGN UNITS (metric) SCALE 5:1 SIZE A4	GENERAL TOLERANCES (UNLESS SPECIFIED)		APPROVE BY FRANK	DATE 10/AUG/22	PART NO. FUS660-FSBBKM	ITEM NO. FUS660	 Leader Of Industry
	X.±0.30	X.±5°	CHECKED BY CHERRY	DATE 10/AUG/22	TITLE USB C-type 90° Angle Female(SMT)(3.1)		
	X.XX±0.15	.XX'±1°	DRAWN BY QING	DATE 10/AUG/22	THIS DRAWING CONTAINS INFORMATION THAT IS PROPRIETARY TO TXGA INDUSTRIAL ELECTRONICS(S.Z)CO.,LTD AND SHOULD NOT BE USED WITHOUT WRITTEN PERMISSION		
	X.XXX±0.10	.XXX'±0.5°					

REV	LOCATIONS	DESCRIPTION	DATE	REVISER	APPD

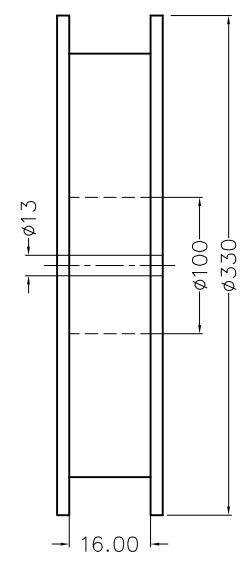
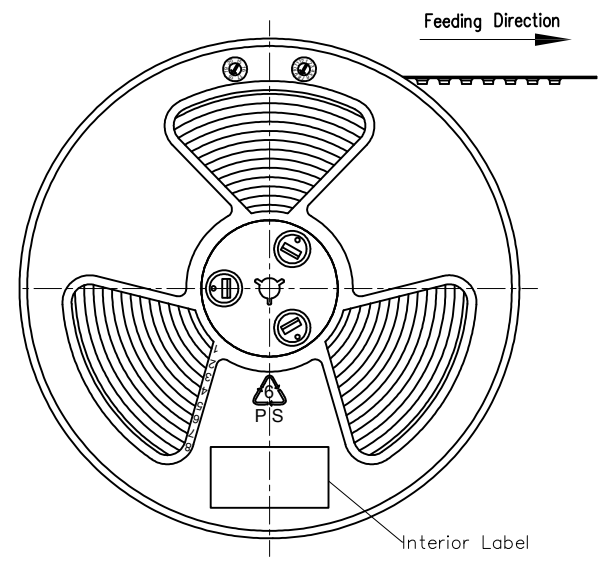

- Note:
- 1.10 sprocket hole cumulative tolerance  $\pm 0.2$
  2. Carrier camber is within 1.0mm in 250mm
  3. Material: Clear conductive polystyrene Alloy 100% recyclable
  4. All dimensions meet EIA-481-3 requirements
  5. Peel off force of cover tape & carrier tape: 20g~130g (0.2N~1.3N)
  6. Component load per 13" reel: 600 pcs

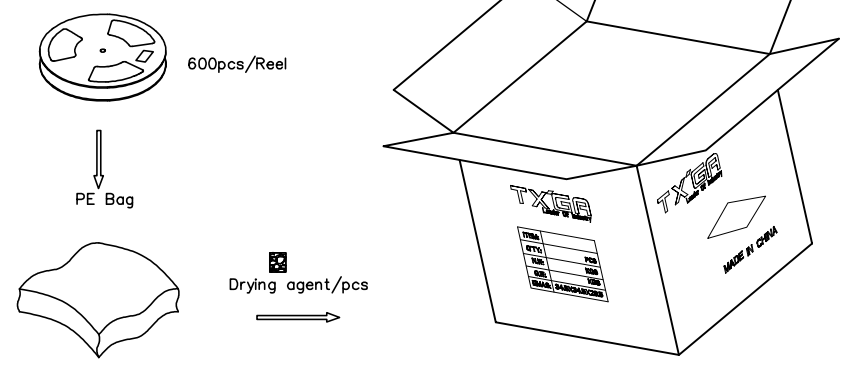
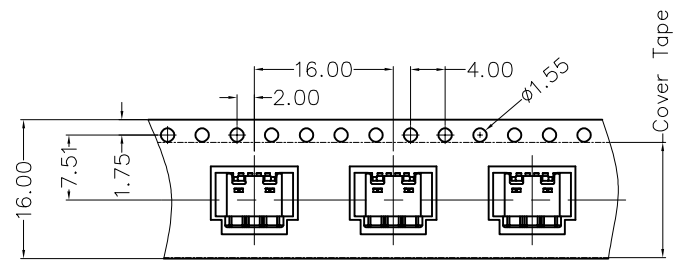
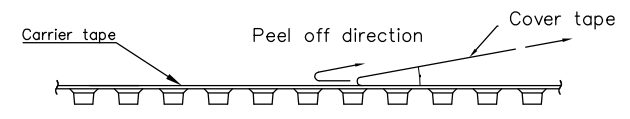
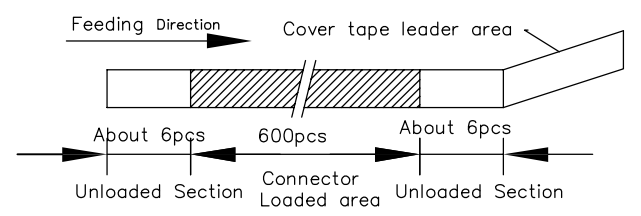

 THIRD ANGLE PROJECTION	GENERAL TOLERANCES (UNLESS SPECIFIED)		APPROVE BY FRANK	DATE 10/AUG/22	PART NO. FUS660-FSBBKM	ITEM NO. FUS660	 Leader Of Industry
	DESIGN UNITS (metric)	X.±0.30	X.±5'	CHECKED BY CHERRY	DATE 10/AUG/22	TITLE USB C-type 90° Angle Female(SMT)(3.1)	
SCALE 5:1	SIZE A4	X.XX±0.15	.XX'±1"	DRAWN BY QING	DATE 10/AUG/22	THIS DRAWING CONTAINS INFORMATION THAT IS PROPRIETARY TO TXGA INDUSTRIAL ELECTRONICS(S.Z)CO.,LTD AND SHOULD NOT BE USED WITHOUT WRITTEN PERMISSION	
		X.XXX±0.10	.XXX'±0.5'			REV 0	SHEET NO. 2/2