

REV	LOCATIONS	DESCRIPTION	DATE	REVISER	APPD

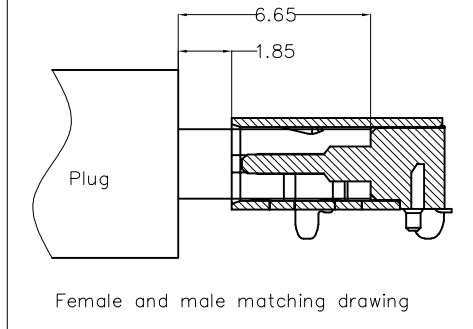
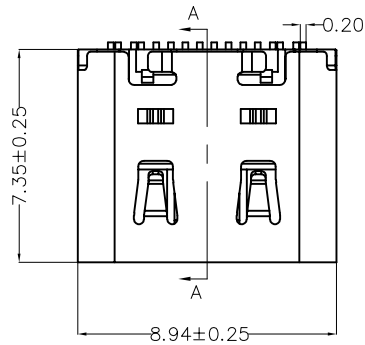

**SPECIFICATIONS**

**Electrical**

Current Rating: 5.0A AC(rms)/DC  
Voltage Rating: 5.0V AC(rms)/DC  
Contact Resistance: 50 mΩ Max  
Insulation Resistance: 100 MΩ Min  
Withstanding Voltage: 100V AC r.m.s  
Operating Temperature: -25°C~+85°C

**Mechanical**

Durability: 5000 cycles Min.  
Mating force: 0.5-2.0KG.F  
Retention force: 0.8-2.0KG.F

**Material and plating**

Housing: LCP (UL 94V-0), Black  
Contacts: Copper Alloy/Gold Plated  
Shell: Stainless steel/Nickel Plated

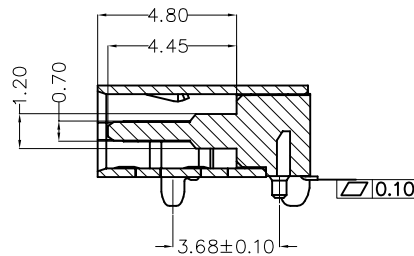
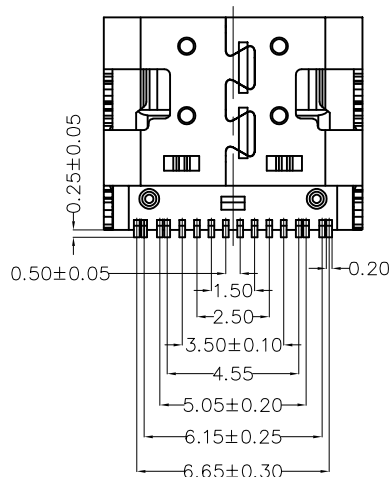
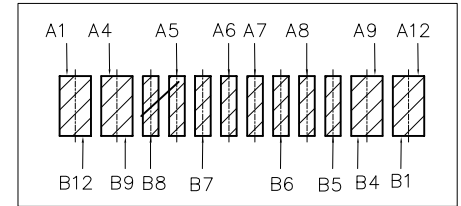
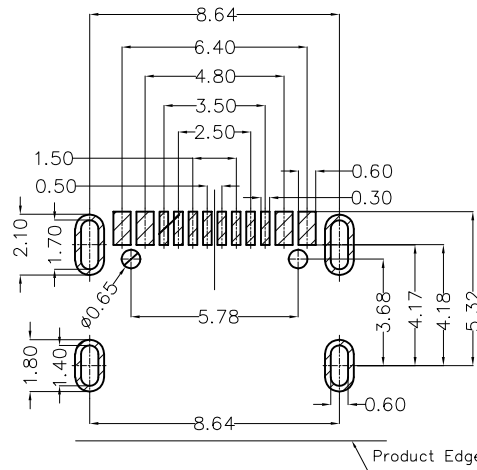
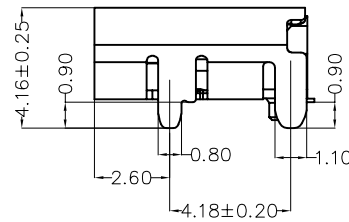
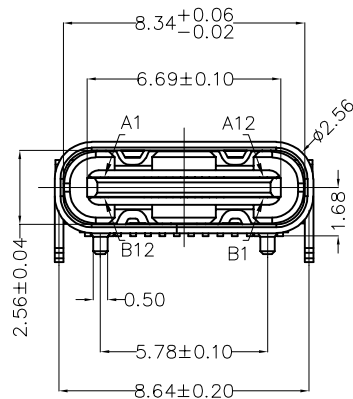

Recommended P.C.Board Layout  
General tolerances ±0.05mm

Circuits	A	Circuits	B
A1	GND	B12	GND
A4	VBUS	B9	VBUS
A5	CC1	B8	SBU2
A6	DP1	B7	DN2
A7	DN1	B6	DP2
A8	SBU1	B5	CC2
A9	VBUS	B4	VBUS
A12	GND	B1	GND

 THIRD ANGLE PROJECTION DESIGN UNITS (metric) SCALE 5:1 SIZE A4	GENERAL TOLERANCES (UNLESS SPECIFIED) X.±0.30 X.±5° X.XX±0.15 .XX'±1" X.XXX±0.10 .XXX'±0.5"		APPROVE BY FRANK CHECKED BY CHERRY DRAWN BY QING	DATE 11/AUG/22 DATE 11/AUG/22 DATE 11/AUG/22	PART NO. FUS661-FSBBKM TITLE USB C-type 90° Angle Female(SMT)(3.1)	ITEM NO. FUS661 REV 0	 Leader Of Industry SHEET NO. 1/2
	THIS DRAWING CONTAINS INFORMATION THAT IS PROPRIETARY TO TXGA INDUSTRIAL ELECTRONICS(S.Z)CO.,LTD AND SHOULD NOT BE USED WITHOUT WRITTEN PERMISSION						

REV	LOCATIONS	DESCRIPTION	DATE	REVISER	APPD

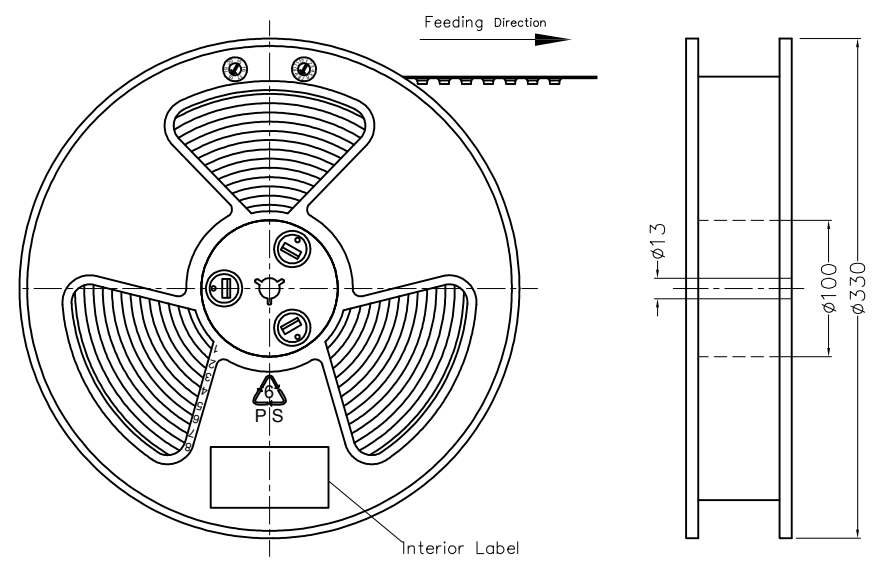

- Note:
- 1.10 sprocket hole cumulative tolerance  $\pm 0.2$
  2. Carrier camber is within 1.0mm in 250mm
  3. Material: Clear conductive polystyrene Alloy 100% recyclable
  4. All dimensions meet EIA-481-3 requirements
  5. Peel off force of cover tape & carrier tape: 20g~130g (0.2N~1.3N)
  6. Component load per 13" reel: 800 pcs

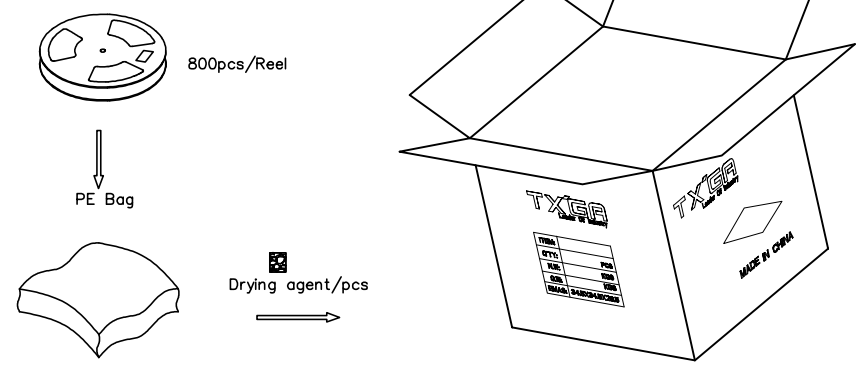
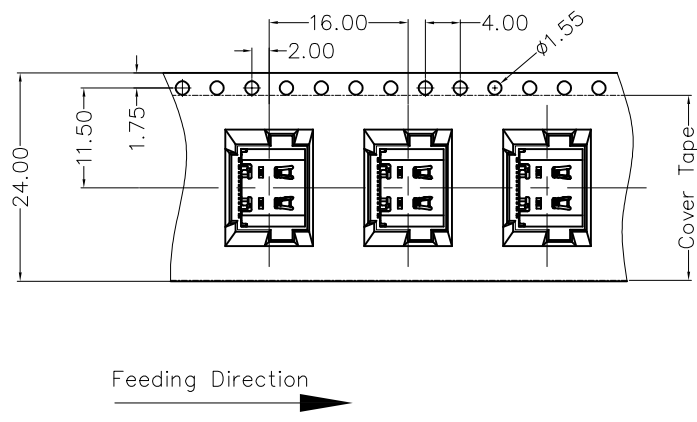
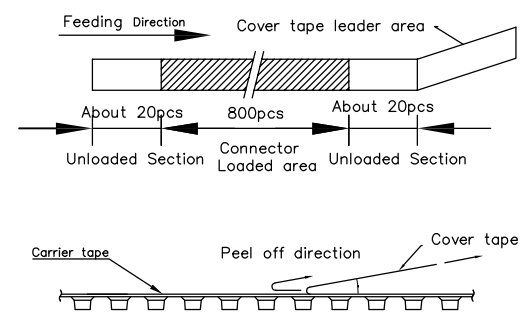

 THIRD ANGLE PROJECTION	GENERAL TOLERANCES (UNLESS SPECIFIED)		APPROVE BY	DATE	PART NO.	ITEM NO.	 Leader Of Industry	
	X.±0.30	X.±5'	FRANK	11/AUG/22	FUS661-FSBBKM	FUS661		
	DESIGN UNITS (metric)		CHECKED BY	DATE	TITLE			REV 0
	X.X±0.20	.X'±2'	CHERRY	11/AUG/22	USB C-type 90° Angle Female(SMT)(3.1)			SHEET NO. 2/2
SCALE	SIZE	X.XX±0.15	.XX'±1"	DRAWN BY	DATE	THIS DRAWING CONTAINS INFORMATION THAT IS PROPRIETARY TO TXGA INDUSTRIAL ELECTRONICS(S.Z)CO.,LTD AND SHOULD NOT BE USED WITHOUT WRITTEN PERMISSION		
5:1	A4	X.XXX±0.10	.XXX'±0.5'	QING	11/AUG/22			