

REV	LOCATIONS	DESCRIPTION	DATE	REVISER	APPD

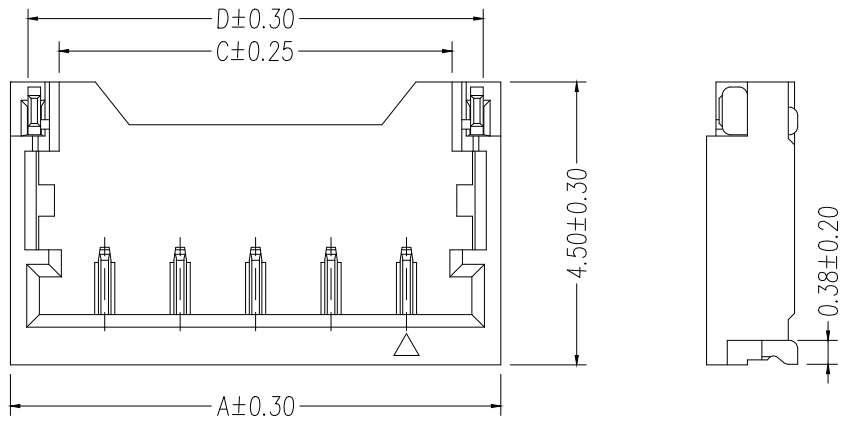

SPECIFICATIONS

Electrical
 Current Rating: 1.5A AC/DC
 Voltage Rating: 50V AC/DC
 Contact Resistance: 20mΩ MAX
 Insulation Resistance: 100 MΩ MIN
 Withstanding Voltage: 500V AC/minute
 Temperature Range-Operating: -40°C~+105°C

Material
 Housing: LCP (UL94V-0),Black
 Terminal: Copper Alloy,Gold flash
 Solder Tab: Copper Alloy,Tin-Plated
 Mates With Housing: FHG12003 Series

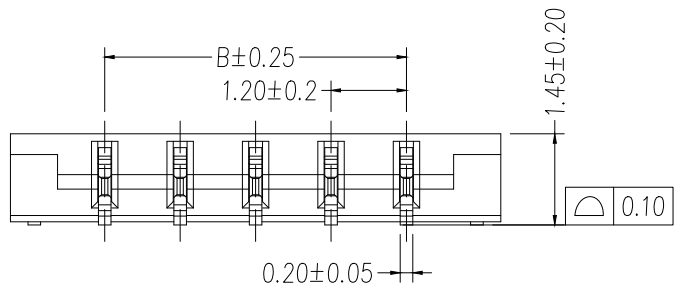

Circuits (n)	Part NO.	Dimensions			
		A	B	C	D
2	FWF12003-S02B13BKM	4.20	1.20	2.65	3.64
3	FWF12003-S03B13BKM	5.40	2.40	3.85	4.84
4	FWF12003-S04B13BKM	6.60	3.60	5.05	6.04
5	FWF12003-S05B13BKM	7.80	4.80	6.25	7.24
6	FWF12003-S06B13BKM	9.00	6.00	7.45	8.44
7	FWF12003-S07B13BKM	10.20	7.20	8.65	9.64
8	FWF12003-S08B13BKM	11.40	8.40	9.85	10.84
9	FWF12003-S09B13BKM	12.60	9.60	11.05	12.04
10	FWF12003-S10B13BKM	13.80	10.80	12.25	13.24
11	FWF12003-S11B13BKM	15.00	12.00	13.45	14.44
12	FWF12003-S12B13BKM	16.20	13.20	14.65	15.64

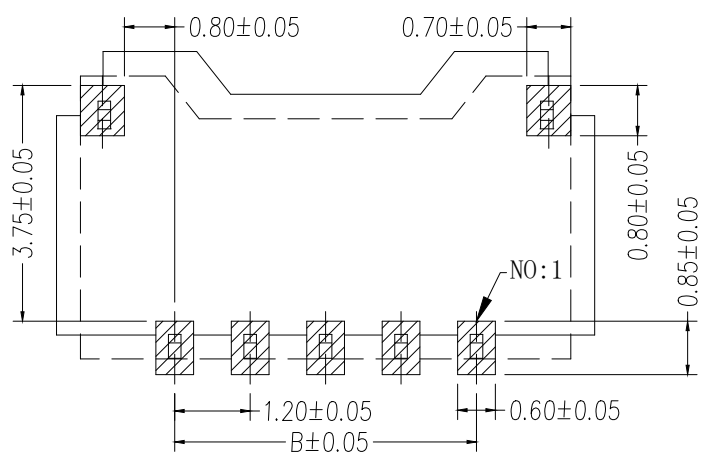

Recommended P.C.Board Layout

Ordering Information

FWF 120 03 - S XX B 1 3 BK M
 1 2 3 4 5 6 7 8 9 10

1 Category FWF-Wafer	2 Series Number 120-Pitch1.20mm	3 Distinction No. 03	4 Row Option S-Single row	5 Circuits XX
6 Entry Angle B-90° Angle	7 Plating 1-Gold Plated	8 Material-Resin 3-LCP	9 Color-Resin BK-Black	10 Packaging M-Reel

 THIRD ANGLE PROJECTION DESIGN UNITS mm SCALE 5:1 SIZE A4	GENERAL TOLERANCES (UNLESS SPECIFIED)		APPROVE BY LEO	DATE 21/Oct/21	PART NO. FWF12003-SXXB13BKM	ITEM NO. FWF12003	 Building Technology Cornerstone	
	X. ±0.30	X.* ±5'	CHECKED BY GISELLE	DATE 21/Oct/21	TITLE Wire to Board Pitch 1.20mm (Wafer)			REV 0
	X.X ±0.20	X.X' ±2'	DRAWN BY PYD	DATE 21/Oct/21	THIS DRAWING CONTAINS INFORMATION THAT IS PROPRIETARY TO TXGA INDUSTRIAL ELECTRONICS(S.Z)CO.,LTD AND SHOULD NOT BE USED WITHOUT WRITTEN PERMISSION			
	X.XX ±0.15	X.XX' ±1'						

1 2 3 4 5 6 7 8

REV	LOCATIONS	DESCRIPTION	DATE	REVISER	APPD

A
B
C
D
E
F

A
B
C
D
E
F

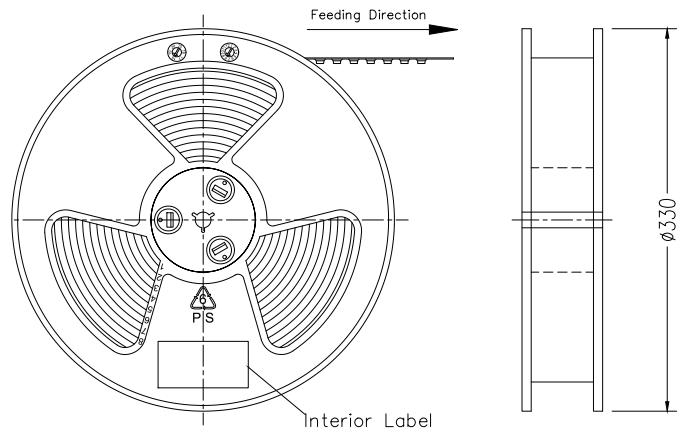

- 10 sprocket hole cumulative tolerance ± 0.2
- Carrier camber is within 1.0mm in 250mm
- Material: Clear conductive polystyrene Alloy 100% recyclable
- All dimensions meet EIA-481-3 requirements
- Peel off force of cover tape & carrier tape: 20g~130g (0.2N~1.3N)
- Component load per 13" reel: 4500 pcs

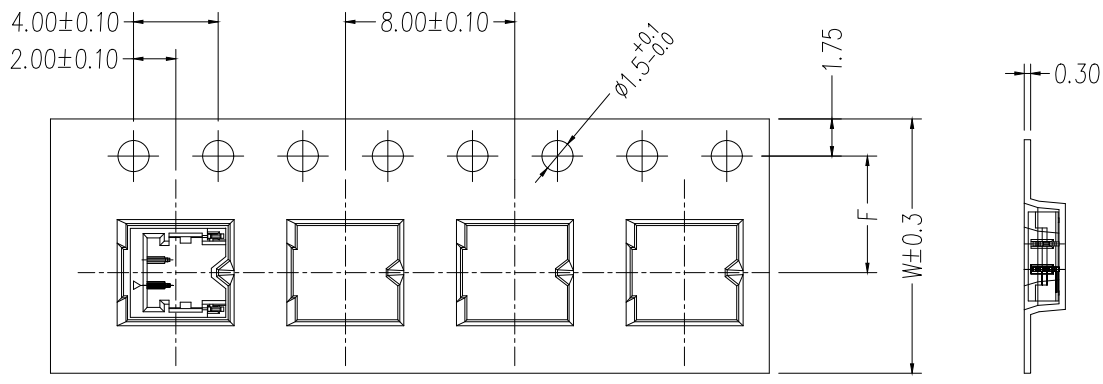
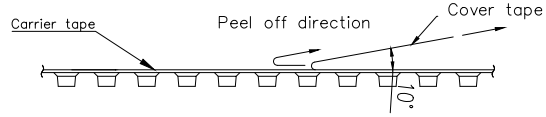
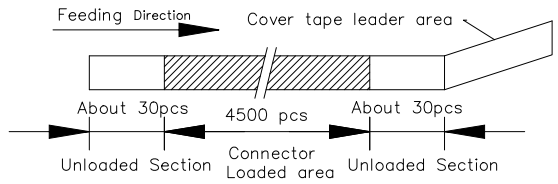

Circuits (n)	Dimensions	
	W	F
2-3	12	5.50
4-6	16	7.50
7-12	24	11.50

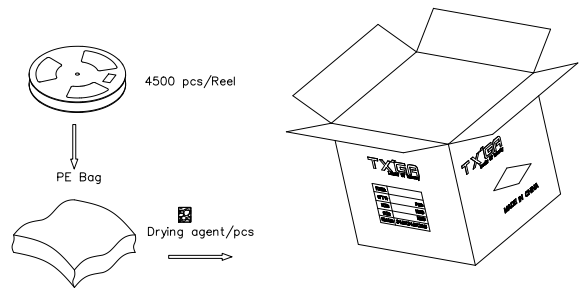

 THIRD ANGLE PROJECTION DESIGN UNITS mm SCALE 5:1 SIZE A4	GENERAL TOLERANCES (UNLESS SPECIFIED)		APPROVE BY LEO	DATE 21/Oct/21	PART NO. FWF12003-SXXB13BKM	ITEM NO. FWF12003	 Building Technology Cornerstone
	X. ±0.30	X.* ±5'	CHECKED BY GISELLE	DATE 21/Oct/21	TITLE Wire to Board Pitch 1.20mm (Wafer)		
	X.X ±0.20	X.X' ±2'	DRAWN BY PYD	DATE 21/Oct/21	THIS DRAWING CONTAINS INFORMATION THAT IS PROPRIETARY TO TXGA INDUSTRIAL ELECTRONICS(S.Z)CO.,LTD AND SHOULD NOT BE USED WITHOUT WRITTEN PERMISSION		
	X.XX ±0.15	X.XX' ±1'					

1 2 3 4 5 6 7 8