

REV	LOCATIONS	DESCRIPTION	DATE	REVISER	APPD

SPECIFICATIONS

Electrical
 Current Rating: 3.0A AC(rms)/DC
 Voltage Rating: 250V AC(rms)/DC
 Contact Resistance: 20 mΩ Max
 Insulation Resistance: 1000 MΩ Min
 Withstanding Voltage: 1000V AC r.m.s
 Temperature Range-Operating: -25°C~+85°C

Material and Plating
 Housing: PA66 (UL 94V-0), White
 Contact: Brass, Gold plated
 Mates With(Housing): FHG25006 Series

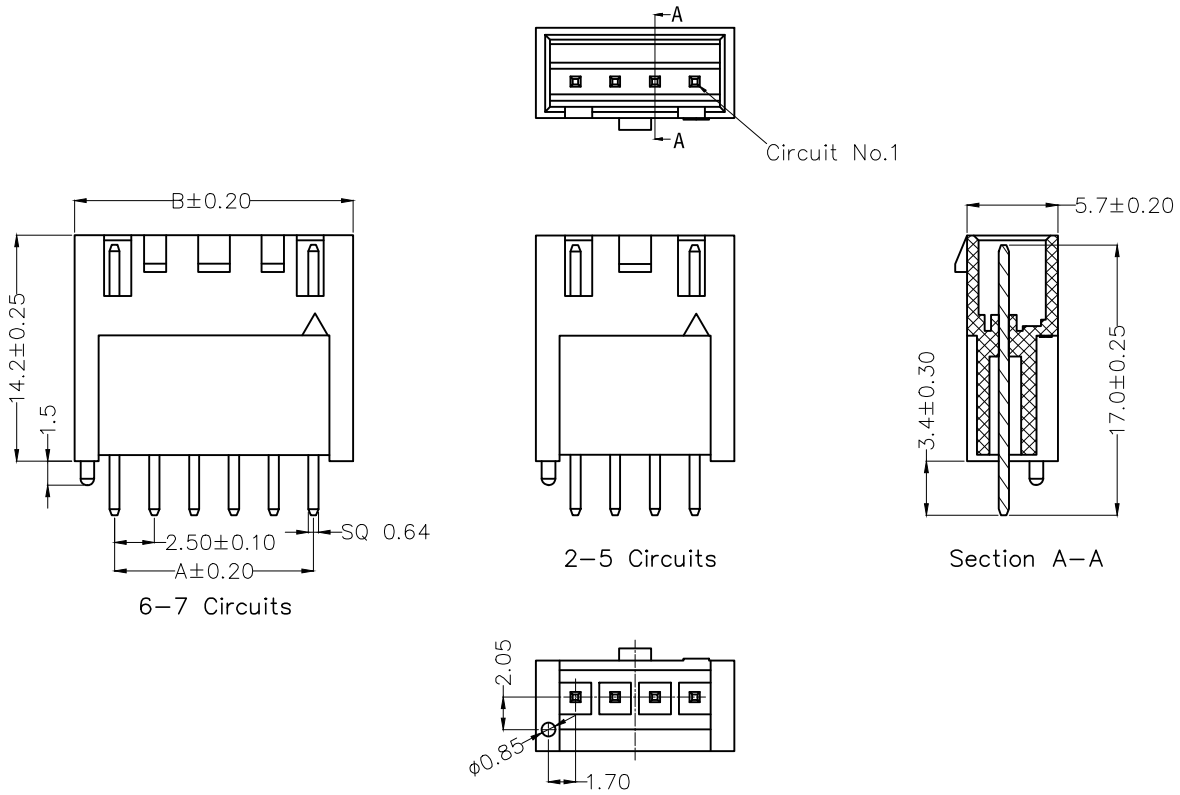

Circuits (n)	Part No.	Dimensions	
		A	B
2	FWF25034-S02S22WHB	2.50	7.50
3	FWF25034-S03S22WHB	5.00	10.00
5	FWF25034-S05S22WHB	10.00	15.00
6	FWF25034-S06S22WHB	12.50	17.50
7	FWF25034-S07S22WHB	15.00	20.00

Ordering Information

FWF 250 34 - S XX S 2 2 WH B
 1 2 3 4 5 6 7 8 9 10

1 Category FWF-Wafer	2 Series Number 250-Pitch 2.5mm	3 Distinction No. 34	4 Row Option S-Single row	5 Circuits XX
6 Entry Angle S-180°Vertical	7 Plating 2-Tin Plated	8 Material-Resin 2-PA66	9 Color-Resin WH-White	10 Packaging B-PE Bag

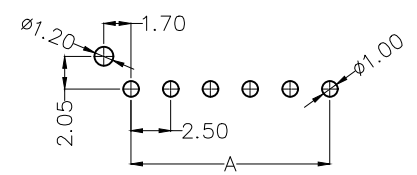

 THIRD ANGLE PROJECTION	GENERAL TOLERANCES (UNLESS SPECIFIED)		APPROVE BY LEO	DATE 18/OCT/23	PART NO. FWF25034-SXXS22WHB	ITEM NO. FWF25034	 Building Technology Cornerstone
	X.±0.40	X.±5°	CHECKED BY GISELLE	DATE 18/OCT/23	TITLE Wire to Board (Wafer) Pitch 2.5mm 180°Vertical (DIP)		
DESIGN UNITS Metric(mm)	X.X±0.30	.X'±2°	DRAWN BY MATT	DATE 18/OCT/23	THIS DRAWING CONTAINS INFORMATION THAT IS PROPRIETARY TO TXGA INDUSTRIAL ELECTRONICS(S.Z)CO.,LTD AND SHOULD NOT BE USED WITHOUT WRITTEN PERMISSION		
SCALE 5:1	SIZE A4	X.XX±0.20					
		X.XXX±0.10					