

1 2 3 4 5 6 7 8

REV	LOCATIONS	DESCRIPTION	DATE	REVISER	APPD
1		Optimized structure of the terminals and solder tab.	17/AUG/18	KATE	FRANK
2		Update tolerances	10/MAY/24	KATE	FRANK

Electrical

Current Rating: 5A AC(rms)/DC
 Voltage Rating: 250V AC(rms)/DC
 Contact Resistance: 20 mΩ Max
 Insulation Resistance: 1000 MΩ MIN
 Withstanding Voltage: 1500V AC r.m.s
 Temperature Range-Operating: -25°C~+85°C

Material and Plating

Housing: PA46(UL 94V-0)
 Contact Pin: Brass/ Tin plated
 Solder tab: Copper alloy/ Tin plated

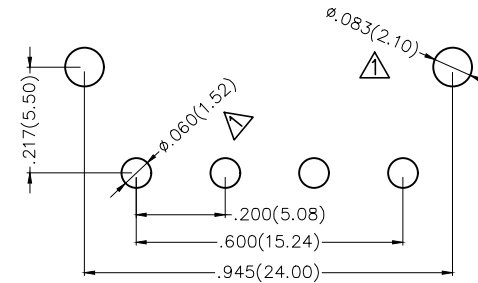
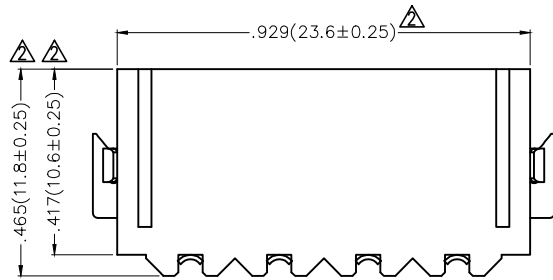
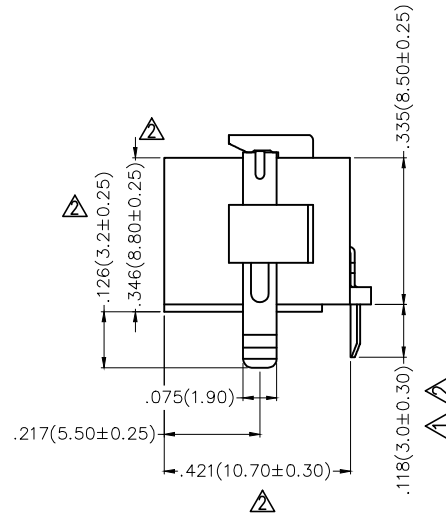
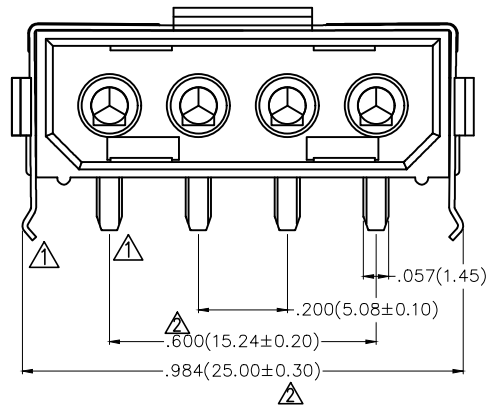

Recommended P.C.Board Layout

A
B
C
D
E
F

A
B
C
D
E
F

1 2 3 4 5 6 7 8

 THIRD ANGLE PROJECTION	GENERAL TOLERANCES (UNLESS SPECIFIED)		APPROVE BY FRANK	DATE 08/JUL/15	PART NO. FWF50804-S04B22K6K	ITEM NO. FWF50804	 Leader Of Industry	
	DESIGN UNITS Inch (metric)	X.±.012(0.30) X.X±.008(0.20) X.XX±.006(0.15) X.XXX±.004(0.10)	X'±5" .X'±2" .XX'±1" .XXX'±0.5"	CHECKED BY CHERRY	DATE 08/JUL/15	TITLE Wire to Board (Wafer) Pitch 5.08mm 90° Angle (DIP)		REV 2
SCALE 5:1	SIZE A4	DRAWN BY KEVIN		DATE 08/JUL/15	THIS DRAWING CONTAINS INFORMATION THAT IS PROPRIETARY TO TXGA INDUSTRIAL ELECTRONICS(S.Z)CO.,LTD AND SHOULD NOT BE USED WITHOUT WRITTEN PERMISSION			