

WIRING CHART		
P1	COLOR	P2 Label
1	White	1
2	White	2
3	White	3
4	White	4
•	•	•
•	•	•
•	•	•
34	White	34
35	White	35
36	White	36
37	White	37

REV	LOCATIONS	DESCRIPTION	DATE	REVISER	APPD

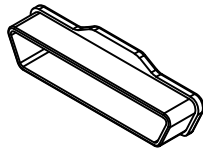

Equipped with dust cover

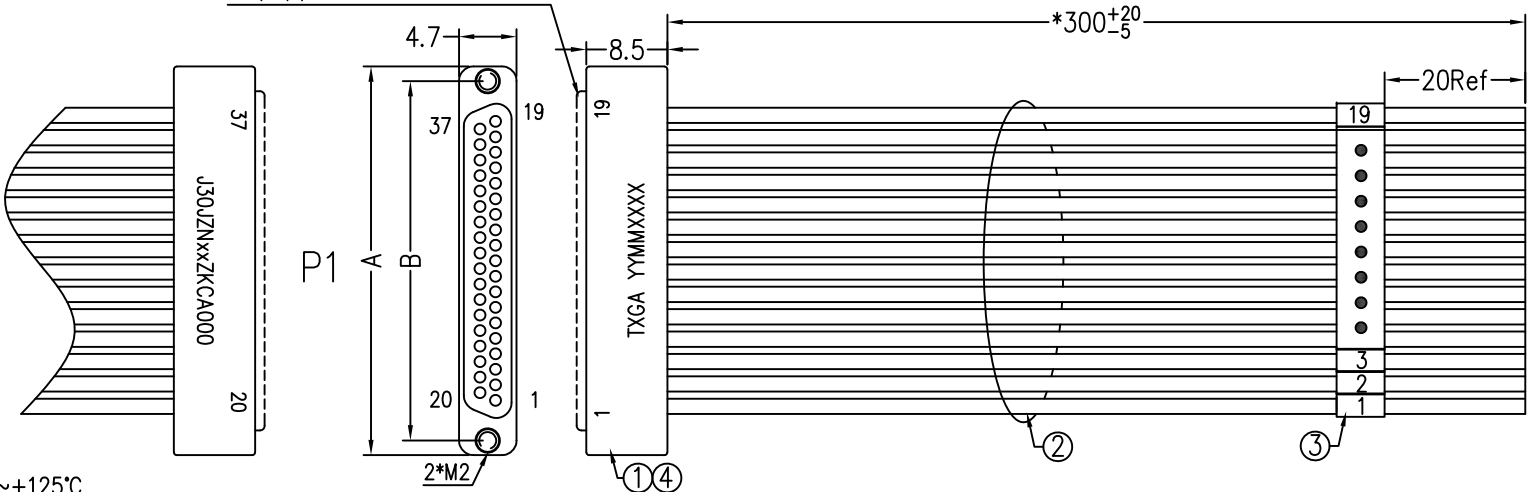

Specifications

Electrical
 Current Rating: 3A
 Voltage Rating: 300V AC(rms)
 Contact Resistance: 10mΩ (MAX)
 Insulation Resistance: 5000MΩ (MIN)
 Temperature Range-Operating: -55°C~+125°C

Mechanical
 Durability: 500 Cycles
 Vibration: Frequency 10~2000Hz, Acceleration 196m/s², Discontinuity 1μs Max.
 Shock: Peak Acceleration 735m/s², Discontinuity 1μs Max.

Material and Plating
 Shell: Aluminum alloy /plated Nickel
 Terminal: Copper alloy /plated Gold
 Wire: Afr250 0.12mm² White

Circuits (n)	Part No.	Dimensions(mm)	
		A	B
9	FWMD0-S0090300-008	14.0	10.6
15	FWMD0-S0150300-008	17.8	14.4
21	FWMD0-S0210300-008	21.6	18.2
25	FWMD0-S0250300-008	24.2	20.8
31	FWMD0-S0310300-008	28.0	24.6
37	FWMD0-S0370300-008	31.8	28.4

4	Dust cover
3	Heat shrink tube ,ø1.0mm ,White
2	AFR250 0.12mm ² ,White
1	J30JZNxxxZKCA000-300
NO.	Specification

<p>THIRD ANGLE PROJECTION</p>	GENERAL TOLERANCES (UNLESS SPECIFIED)		APPROVE BY	DATE	PART NO.	ITEM NO.	<p>Building Technology Cornerstone</p>	
	X. ±0.30	X.' ±5'	LEO	13/JUN/24	FWMD0-SXXX0300-008	FWMD0-		
	DESIGN UNITS mm	X.X ±0.20	X.X' ±2'	CHECKED BY	DATE	TITLE		
	SCALE 5:1	X.XX ±0.15	X.XX' ±1'	GISELLE	13/JUN/24	SINGLE CONDUCTOR CABLE		
SIZE A4	X.XXX ±0.10	X.XXX' ±0.5'	DRAWN BY	DATE	THIS DRAWING CONTAINS INFORMATION THAT IS PROPRIETARY TO TXGA INDUSTRIAL ELECTRONICS(S.Z)CO.,LTD AND SHOULD NOT BE USED WITHOUT WRITTEN PERMISSION		REV 0	SHEET NO. 1/4
			HUANG	13/JUN/24				